

BATTERY REPLACEMENT

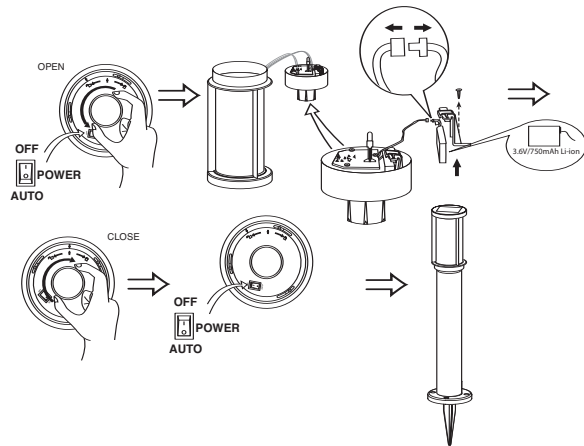

- 1 Remove solar light from post pipe
- 2 Turn light unit upside down
- 3 Turn power switch to OFF
- 4 Rotate plastic base anti clockwise
- 5 Remove base of solar light
- 6 Unscrew battery retainer
- 7 Pull apart white 'push' connector
- 8 Remove old battery
- 9 Insert new battery
- 10 Connect white 'push' connector
- 11 Replace and screw down battery retainer
- 12 Replace base of solar light
- 13 Rotate plastic base clockwise until secure
- 14 Turn power switch to ON / Auto
- 15 Return solar light to post pipe

PRODUCT DISPOSAL



Li-ion battery must be recycled or disposed of properly.



Waste electrical products should not be disposed of with household waste. Please recycle where facilities exist. Check with your Local Authority or retailer for recycling advice.

“Ryobi takes the care of our environment very seriously. Please dispose of all waste electrical and electronic equipment in a responsible and environmentally friendly way.”

CAUTION

Please be aware children should not use these as toys and care should be taken at all times.



The Fine Lighting Company International Ltd.
Medina House, Fieldhouse Lane, Marlow, Bucks SL7 1TB
Tel: 01628 894 400 Fax: 01628 894 401
Email: sales@thefinelightingcompany.com
Web: www.thefinelightingcompany.com
Technical Helpline: 01628 894 500

All of the Fine Lighting Company™ products include a 1 year warranty The Fine Lighting Company™ reserve the right to change images, specifications and prices without prior notice.



DECLARATION OF CONFORMITY

We declare under our sole responsibility that this product is in conformity with the following standards or standardized documents.

Applicable EC Directive:

EC Directive of electromagnetic Compatibility (89/336/EEC) with amendments

Applicable Harmonized Standard:

EN55015/A2:2002
EN61547/A1:2000
EN61000-6-3/A11:2004
Model: SW-323W
Description: 2 Metal Solar Posts

Mark Pearson – Managing Director

SW-323W

AIR

2 Metal Solar Posts

Instruction Manual



AIR

2 Metal Solar Posts

The solar light comprises of a solar cell, rechargeable batteries and LED light source. Light from the sun charges the batteries during the day and at night the energy stored in the batteries is used to power the light.

The length of time the light stays on for is dependent on the amount of sunlight the solar panel has been exposed to during the day.

No other power source or connections are required.

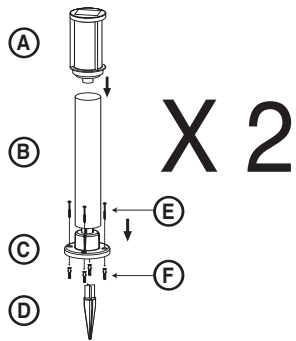

PACK CONTENTS

- 2 x Solar light units (A)
- 2 x Post pipes (B)
- 2 x Deck mounts (C)
- 2 x Cover for deck mounts (Not shown)
- 2 x Ground spikes (D)
- 8 x Fixing screws (E)
- 8 x Dowels (F)

WARNING

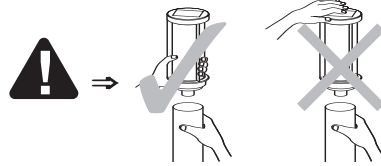

Do not apply pressure to the solar panel.

PRIOR TO USE

Check the pack to make sure you have all the products listed.

Prior to first use, set power switch to "OFF" position and allow battery to charge for 2 days under full sunlight. Repeat this procedure every three months to top up the battery. Please note, this may take longer if there is not constant full sunlight.

Decide on an appropriate location for your product (see Siting Instructions opposite).

ASSEMBLY INSTRUCTIONS (Soft Ground Using Spike)

- 1 Insert Solar light unit into post pipe
- 2 Place metal deck mount cover over the plastic deck mount
- 3 Push post pipe onto deck mount
- 4 Insert ground spike into base of deck mount

ASSEMBLY INSTRUCTIONS (Solid Flat Surfaces)

- 1 Insert Solar light unit into post pipe
- 2 Screw plastic deck mount into position (see Siting Instructions)
- 3 Place Metal deck mount cover over the top
- 4 Push post pipe onto deck mount

SITING INSTRUCTIONS

Solar lights are designed for use outside in an open (un-shaded) location

The solar light should be located where sunlight can fall directly on the unit. Shadows from buildings, trees, walls, hedges or similar should be avoided as these will reduce your light running time.

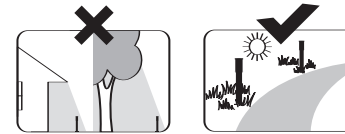

Avoid locations where light from other sources will fall on the panel at night (street lights, floodlights etc) as this may prevent the light from turning on.

The units can be left outside in the rain but should not be exposed to water jets or immersed in any way.

For optimum life, the solar panel should be protected from weather extremes such as snow or frost.

Do not position near direct sources of heat such as patio heaters or barbeques.

PRODUCT SPECIFICATIONS

| | |
|--------------------------------------|---------------------------------------|
| Product Size | 10.5cm (W) x 59.5cm (H) +12cm (spike) |
| Solar Cell | 0.5W Polycrystal |
| Light Source Type | 2 x white LED (per unit) |
| Laser Category | Class 1 |
| Surface Material | Die cast Zinc |
| Battery Type | 1 x 3.6V Li-ion 750mAh (per unit) |
| Maximum UK operating Time (summer) | 12 hrs |
| Maximum UK operating Time(winter) | 8 hrs |
| Maximum operating Time (full charge) | 20 hrs |

The solar panel is designed to be placed where the ground is soft so that the ground spike can be pushed in easily.

CARE & USE

Periodically wipe clean with a soft dry cloth. Never use scourers, abrasives or chemical cleaners. Do not allow water to come into contact with electric components.

The solar panel lens should be cleaned periodically to ensure its efficiency is not reduced by dust and dirt.

Some condensation may form inside the lights or solar panel in cold conditions. This is normal and will not affect the performance of your light.

SUMMER / WINTER SETTINGS

In Summer mode: 2 white LEDs will turn on when the power switch is in AUTO position.

In Winter mode: During winter the batteries receive a much lower level of charge this reduces runtime considerably. In winter mode 1 LED light is used allowing for longer run time than would be possible with 2 LEDs.

It is therefore recommended that in summer season you switch to summer mode and in winter season you switch to winter mode for optimum performance.