

Step 9:

INSTALLING SHELVES

With the doors open insert a Shelf (item 4) into cabinet, determine the height of your shelf and secure by inserting its edges of the shelf into the tabs on the right, left and back panels (see detail below).

Repeat step for other shelf.

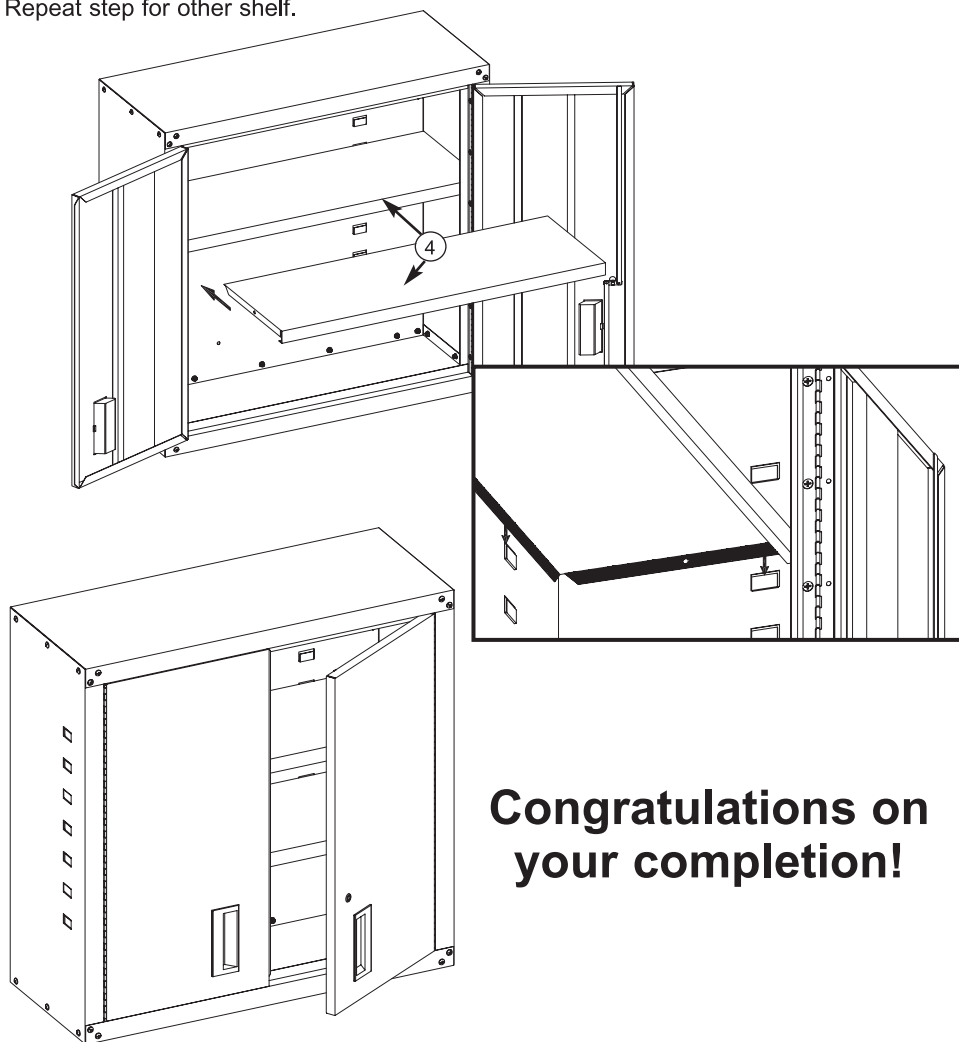

**Congratulations on
your completion!**

If faults cannot be remedied, contact the Helpline on 020 8391 6767
helpline@hilka.co.uk

Hilka Tools UK Ltd.
1 ROEBUCK PLACE, ROEBUCK ROAD, CHESSINGTON, SURREY KT9 1 EU

Hilka

GARAGE WALL UNIT

WC2D

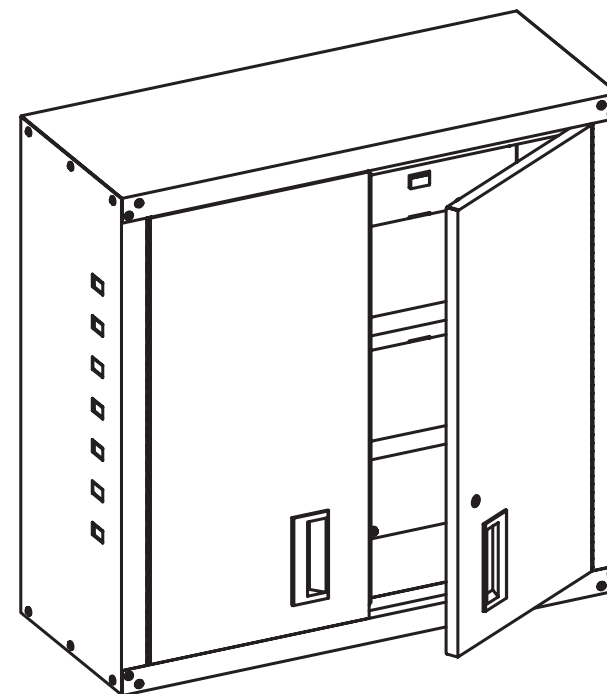

Part No: 49987

To make assembly easier we recommend having two persons aid one another in assembly.

Item	Description	Qty.
1	Left Side Panel	1
2	Right Side Panel	1
3	Back Panel	1
4	Shelves	2
5	Top Panel	1
6	Bottom Panel	1
7	Left Door	1
8	Right Door w/ Lock	1
9	Door handles	2
10	Lag Screw	4
11	Fender Washer	4
12	Sheet Metal Screw	12
13	Flanged Lock Nut	40
14	Phillips Head Screw	40
15	Key	2

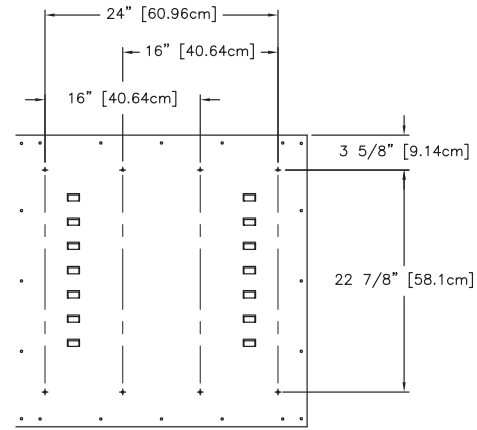
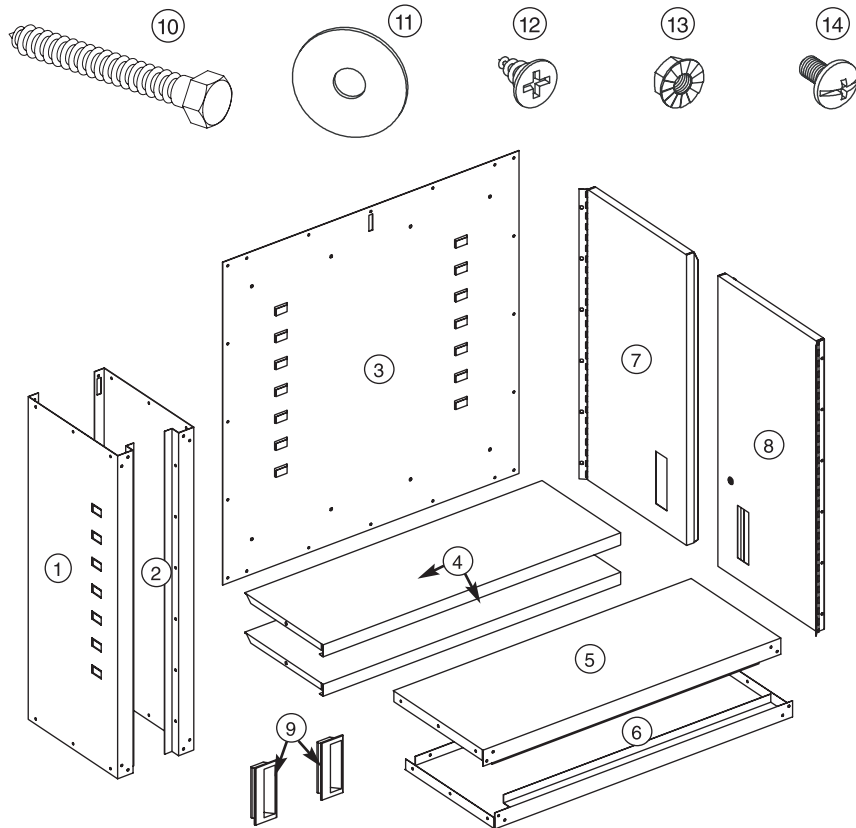
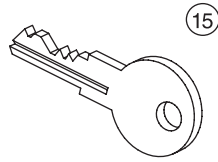

Step 1: MOUNTING PREPARATION

First locate and determine the spacing of your wall studs. Using the Back Panel (Item 3) as a template, align the Back Panel mounting holes to the stud location where the Lag Screws (Item 10) will be inserted. Use the detail to the left and below as guides to determine which set of holes best fit the wall.

24" [61,0cm] Studs - Use the 4 outer mounting holes.

16" [40,6cm] Studs - You have two options refer to detail and determine which set of 4 mounting holes (16" [40,6cm] apart) to use.

Before drilling any holes double check locations of your hole center marks. Use a level to check your marking heights. Use a drill with a 1/8" [3.2mm] drill bit and drill pilot holes about 1" [3cm] deep at the center marks.

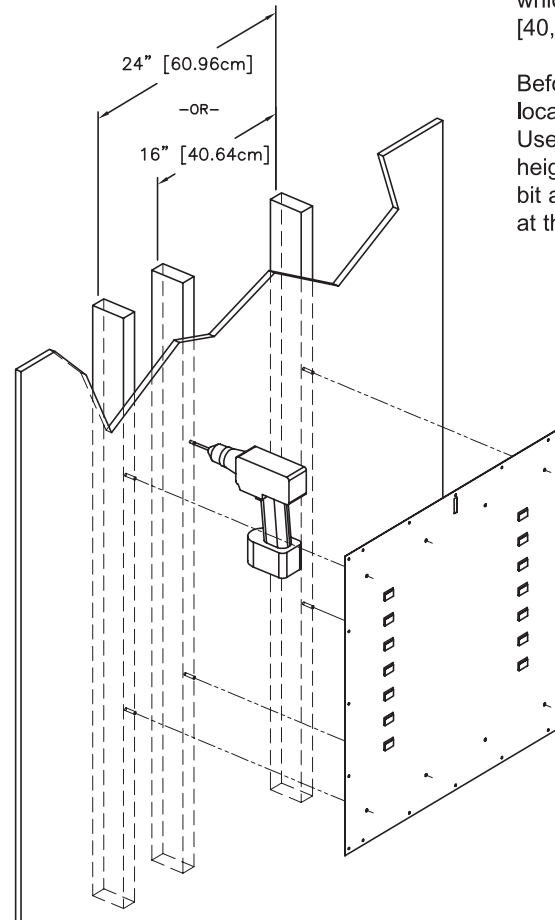

Step 2:

SIDE PANEL ASSEMBLY

Attach Side Panels (items 1 & 2) to Bottom Panel (item 6) with Phillips Head Screws (item 14) and Flanged Lock Nuts (item 13). Secure panels in the front with phillips head screws and flanged lock nuts (see detail below).

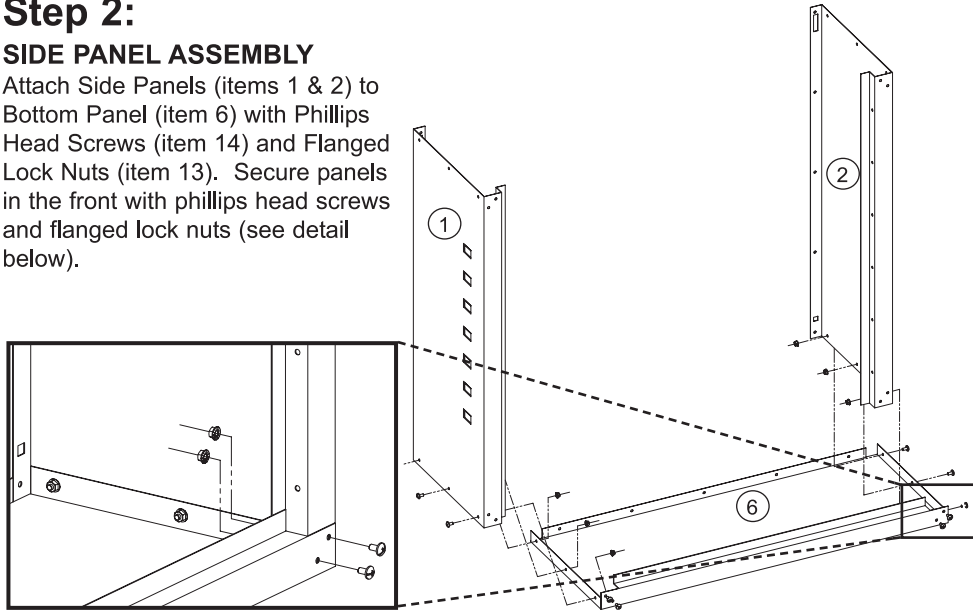

Step 3:

BACK PANEL ASSEMBLY

Insert Back Panel (item 3) into cabinet assembly. Align panel corner holes and insert phillips head screws into holes and secure with flanged lock nuts (see detail below).

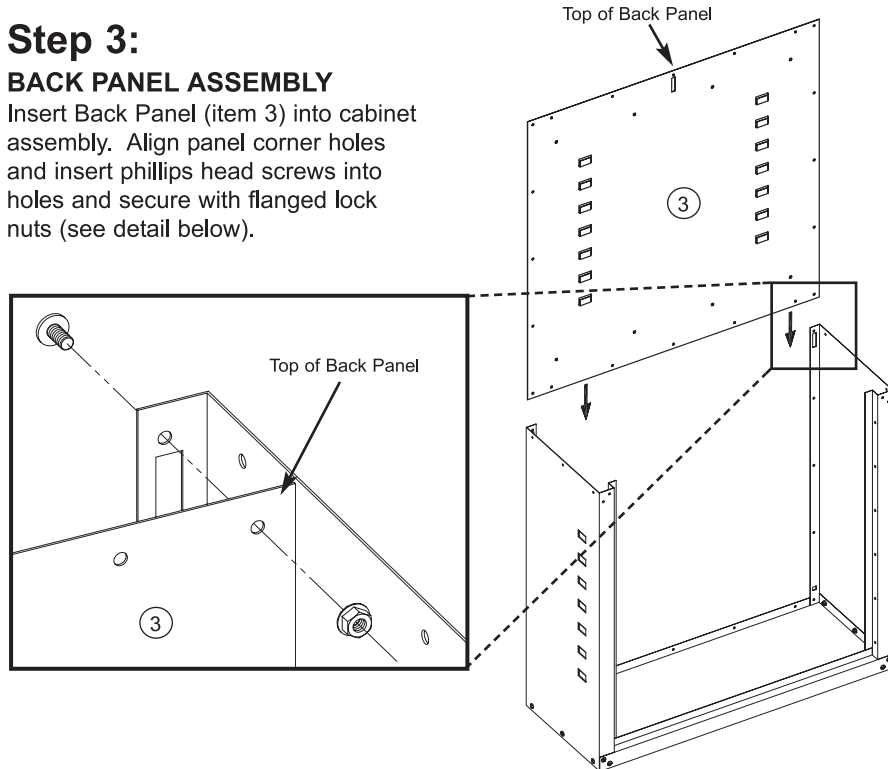

Step 4:

SECURING BACK PANEL

Insert phillips head screws and flanged lock nuts into the side and bottom holes of the Back Panel as shown.

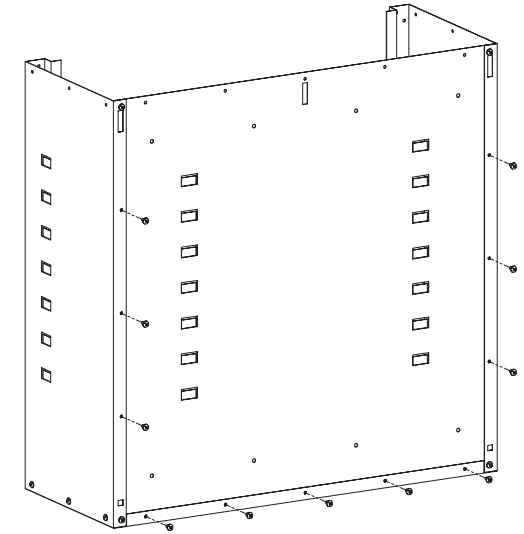

Step 5:

TOP PANEL ASSEMBLY

Assemble Top Panel (item 5) to cabinet assembly. Align holes on the sides and back and secure with phillips head screws and flanged lock nuts.

Secure panels in front with phillips head screws and flanged lock nuts (see detail below).

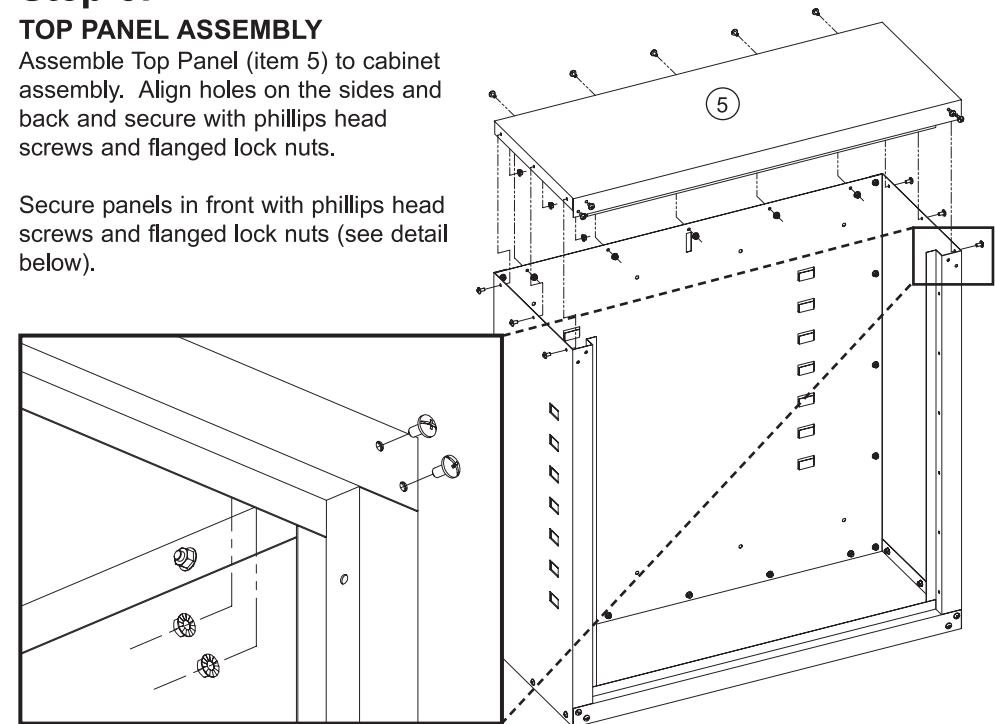

Step 6:

DOOR HANDLE ASSEMBLY

Before attaching the Right and Left Doors (items 7&8) to the cabinet assembly, insert the Door Handles (item 9).

First slide in the back of the handle and then firmly press in the front until the locking clip snaps into place (see details).

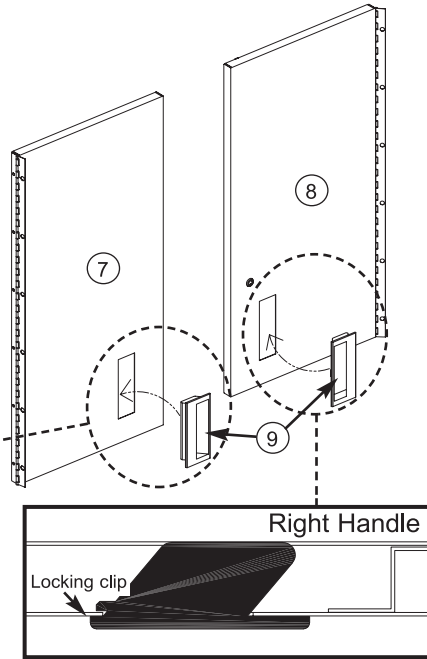
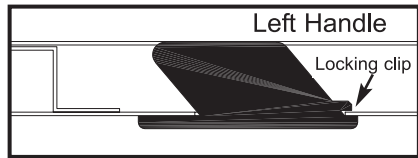

Step 7:

ACCESS DOOR ASSEMBLY

Align the holes on the hinges of the left door to the holes on the Side Panel and secure together with Sheet Metal Screws (item 12) (see illustration to the right).

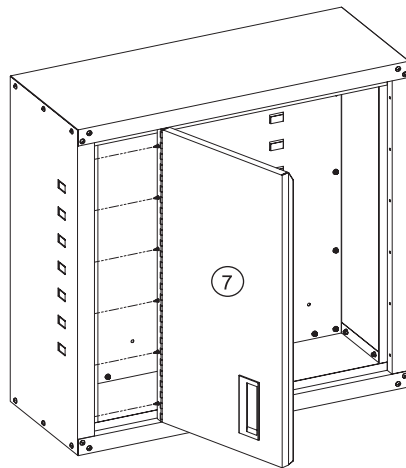
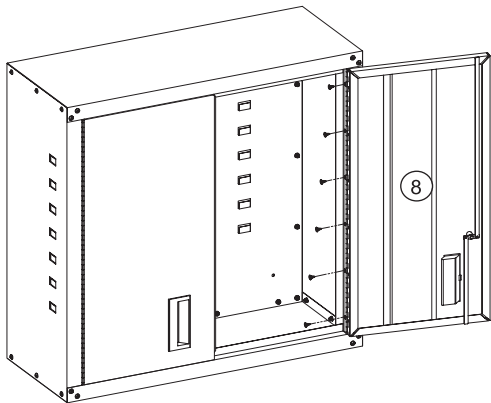

Repeat previous step to attach the right door with lock to the cabinet assembly (see illustration to the left).

Step 8:

INSTALLING CABINET TO WALL

Open doors to help align the mounting holes on the back panel to the pre-drilled pilot holes on the wall (refer to Step 1). Use a 7/16" (11mm) socket wrench to insert and fasten the Lag Screws with the Fender Washers (items 10&11) to wall studs (see illustration detail below).

