

Little Fingers Heavy Duty Fitting Instructions

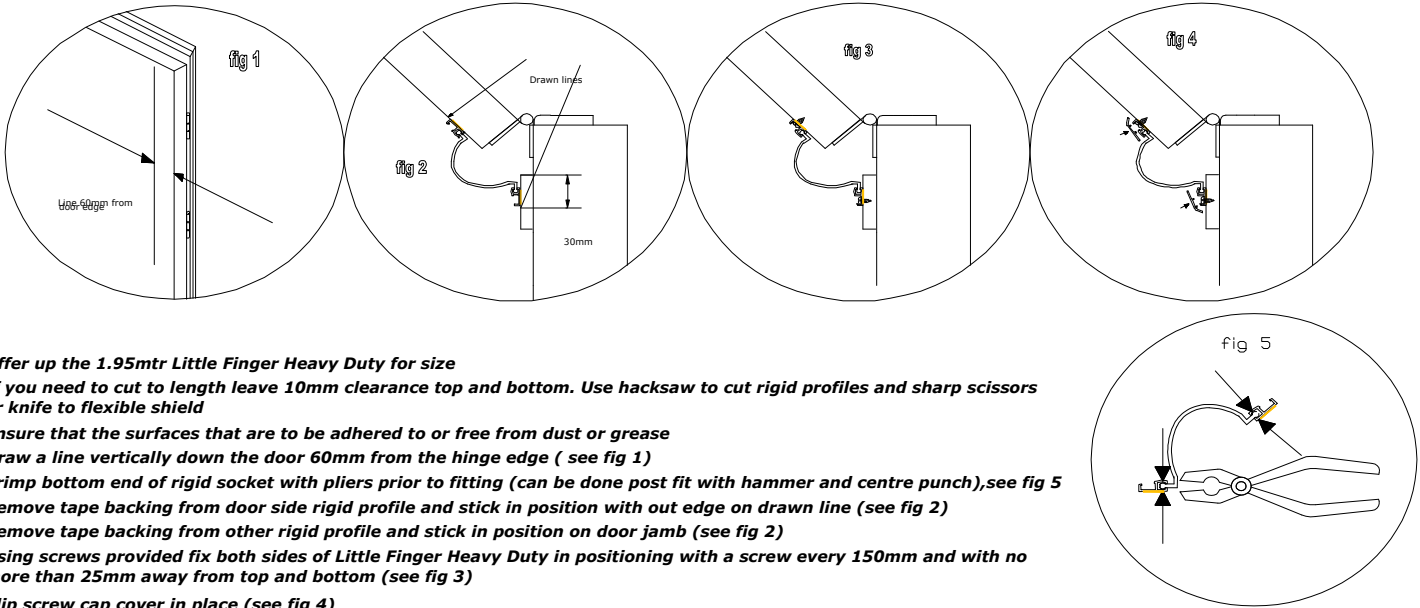

- 1 Offer up the 1.95mtr Little Finger Heavy Duty for size
 - 2 If you need to cut to length leave 10mm clearance top and bottom. Use hacksaw to cut rigid profiles and sharp scissors or knife to flexible shield
 - 3 Ensure that the surfaces that are to be adhered to or free from dust or grease
 - 4 Draw a line vertically down the door 60mm from the hinge edge (see fig 1)
 - 5 Crimp bottom end of rigid socket with pliers prior to fitting (can be done post fit with hammer and centre punch),see fig 5
 - 6 Remove tape backing from door side rigid profile and stick in position with out edge on drawn line (see fig 2)
 - 7 Remove tape backing from other rigid profile and stick in position on door jamb (see fig 2)
 - 8 Using screws provided fix both sides of Little Finger Heavy Duty in positioning with a screw every 150mm and with no more than 25mm away from top and bottom (see fig 3)
 - 9 Clip screw cap cover in place (see fig 4)
- Finished

Maintenance

The only maintenance that may be required on Little Finger Heavy Duty is an occasional wipe down with a damp cloth

Please note that double sided tape is only applied as a fitting aid and the Little Finger should be fixed using screws provided before use

IMPORTANT NOTICE: PRODUCT MUST NOT BE COLD WHEN FITTED AND SHOULD BE STORED AT NORMAL ROOM TEMPERATURE FOR 6 HOURS PRIOR TO FITTING

Please be advised neither the seller or manufacturer can be responsible for any damage caused other than fair wear and tear.

Little Fingers Heavy Duty Fitting Instructions

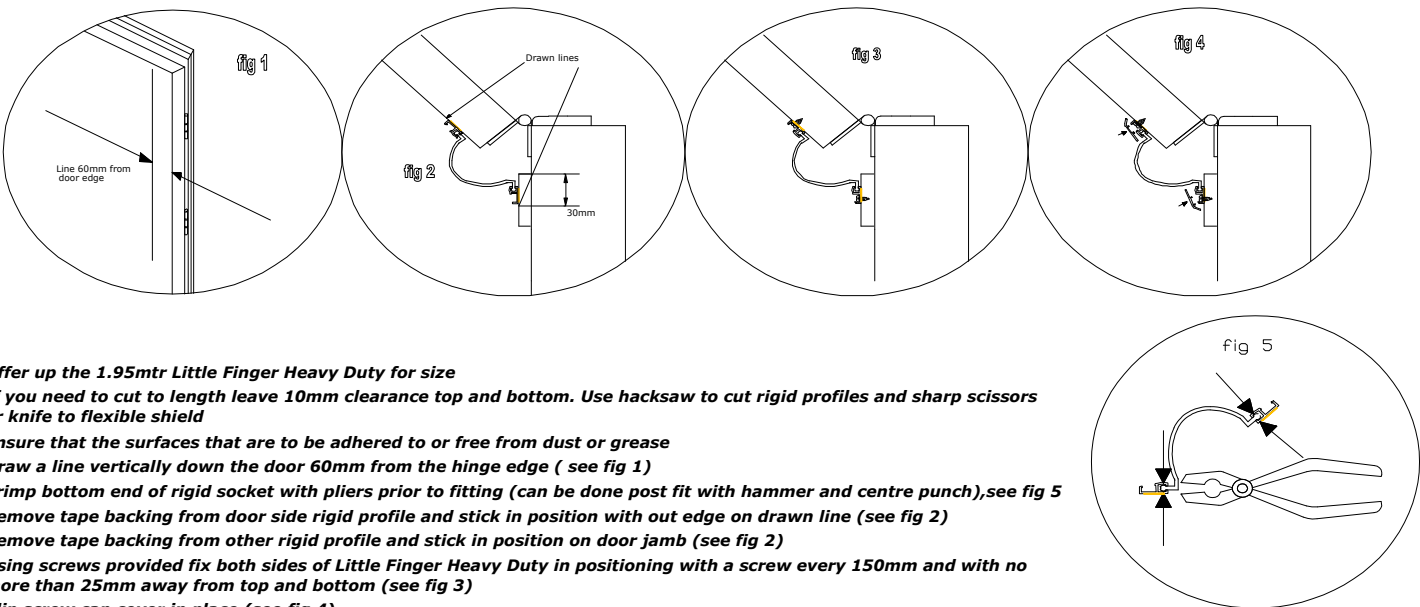

- 1 Offer up the 1.95mtr Little Finger Heavy Duty for size
 - 2 If you need to cut to length leave 10mm clearance top and bottom. Use hacksaw to cut rigid profiles and sharp scissors or knife to flexible shield
 - 3 Ensure that the surfaces that are to be adhered to or free from dust or grease
 - 4 Draw a line vertically down the door 60mm from the hinge edge (see fig 1)
 - 5 Crimp bottom end of rigid socket with pliers prior to fitting (can be done post fit with hammer and centre punch),see fig 5
 - 6 Remove tape backing from door side rigid profile and stick in position with out edge on drawn line (see fig 2)
 - 7 Remove tape backing from other rigid profile and stick in position on door jamb (see fig 2)
 - 8 Using screws provided fix both sides of Little Finger Heavy Duty in positioning with a screw every 150mm and with no more than 25mm away from top and bottom (see fig 3)
 - 9 Clip screw cap cover in place (see fig 4)
- Finished

Maintenance

The only maintenance that may be required on Little Finger Heavy Duty is an occasional wipe down with a damp cloth

Please note that double sided tape is only applied as a fitting aid and the Little Finger should be fixed using screws provided before use

IMPORTANT NOTICE: PRODUCT MUST NOT BE COLD WHEN FITTED AND SHOULD BE STORED AT NORMAL ROOM TEMPERATURE FOR 6 HOURS PRIOR TO FITTING

Please be advised neither the seller or manufacturer can be responsible for any damage caused other than fair wear and tear.