

# TEMPLATE & FITTING INSTRUCTIONS

## PASSAGE DOOR KNOB SET

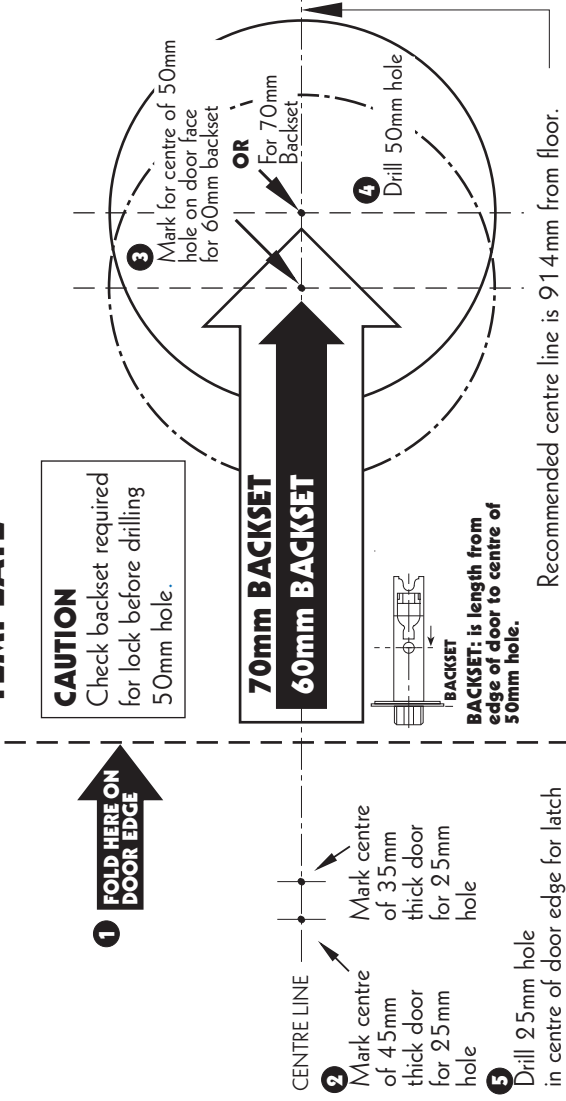

### TEMPLATE



Call 01922 490000 for your FREE brochure  
www.era-security.com

**TECHNICAL HELPLINE**  
**01922 490 050**

Reduce the risk with ERA PRODUCTS LTD

# FITTING INSTRUCTIONS

To fit the door set you will require the following:  
Power drill, 50mm and 25mm drill bits, Hammer,  
Chisel, Posidriv Screwdriver, Bradawl

### Contents

2 x knobs, latch, striker plate & fixings.

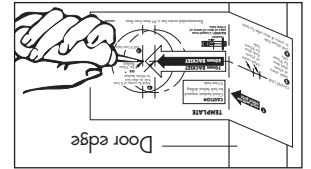

**A Mark Door**  
Mark centre of door edge and centre hole on door face using the enclosed template. Using the centre line on the template mark the frame. From this mark measure into the centre of the frame and mark.

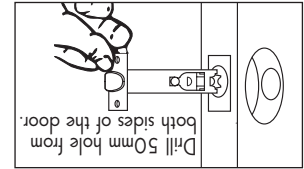

**B Drill Two Holes**  
Drill a 50mm hole through the door face as marked and a 25mm hole in the door edge long enough to reach through to the 50mm hole already drilled. Insert the latch into the door and mark around the forend. Recess to a depth of 2mm to allow latch to fit flush against the door. Fit latch using the screws provided.

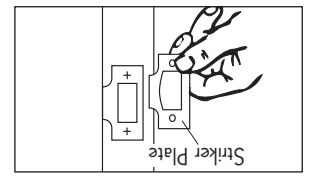

**C Install Striker**  
Drill a 25mm hole in the frame where previously marked (If plastic dust pocket is used, chisel frame to suit) Screw striker plate over the hole using screws provided. (recess if necessary)

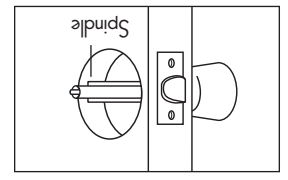

**D Install External Knob**  
Insert external handle into the latch ensuring the spindle and stems position correctly into the latch. Press flush against the door.

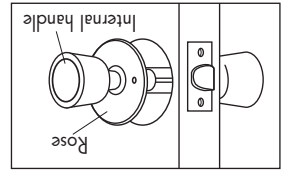

**E Install Internal Assembly**  
Insert internal handle over the spindle ensuring the fixing holes on rose are horizontal. Use bolts provided to fasten handles together.

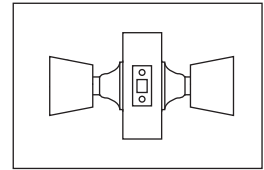

**F Opening test**  
Check operation of lock set by turning both internal and external handle.