

QJ41444

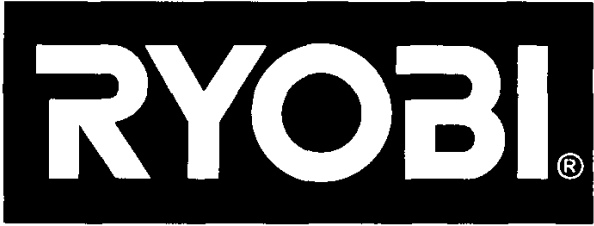

EPN-6082  
EPN-7582N

**PLANER  
OWNER'S OPERATING MANUAL**

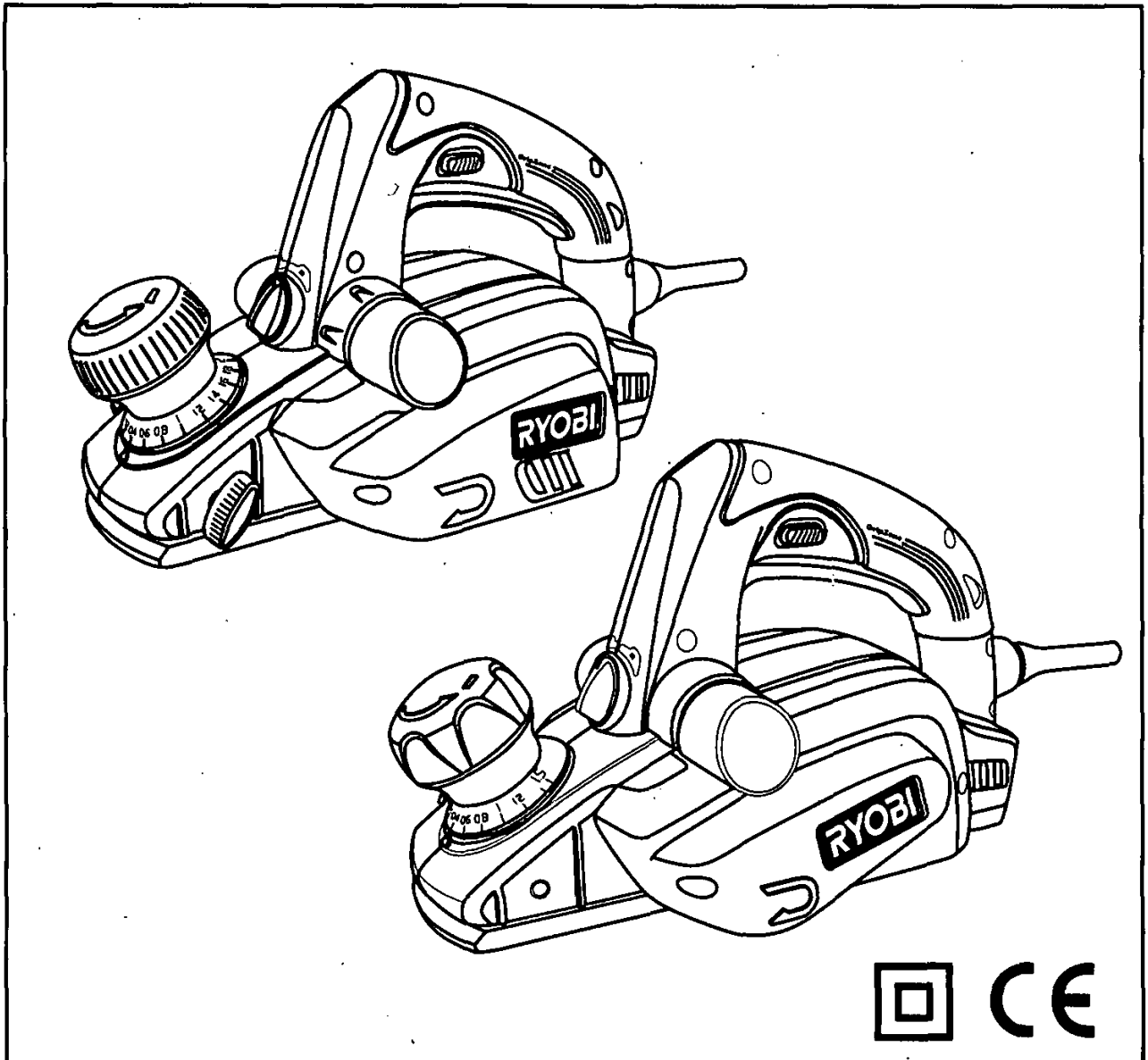

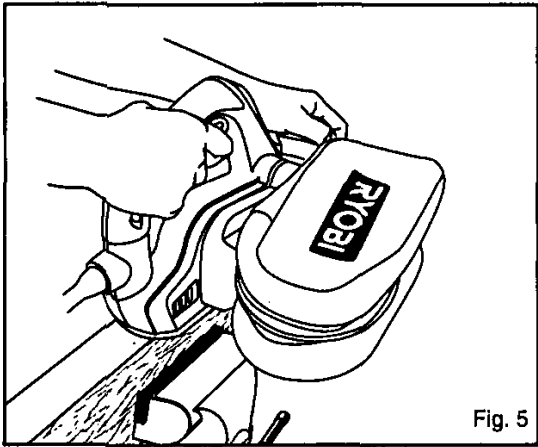

Fig. 5

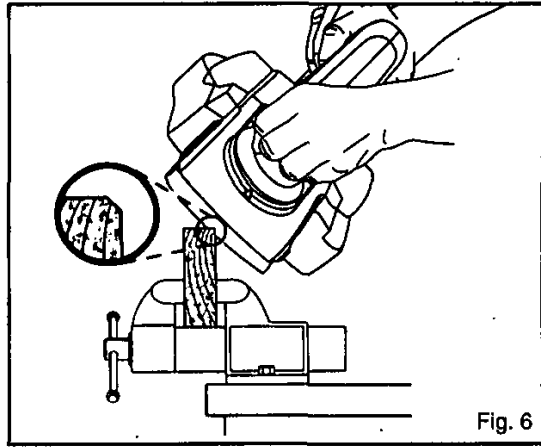

Fig. 6

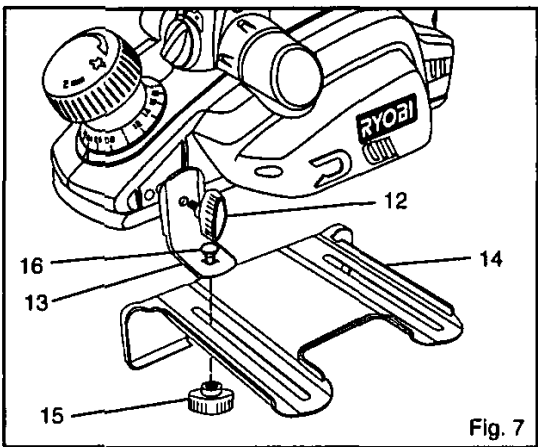

Fig. 7

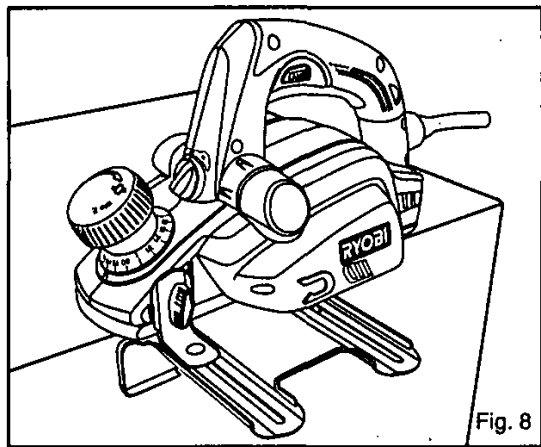

Fig. 8

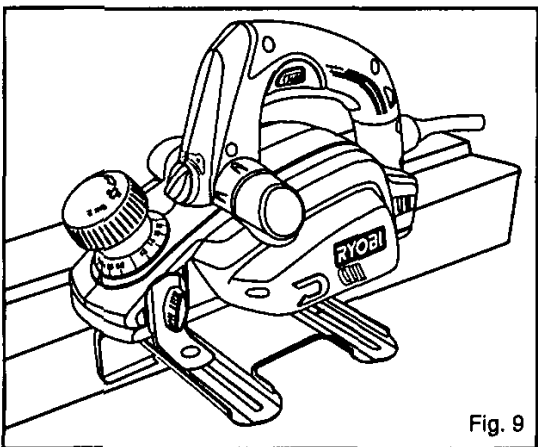

Fig. 9

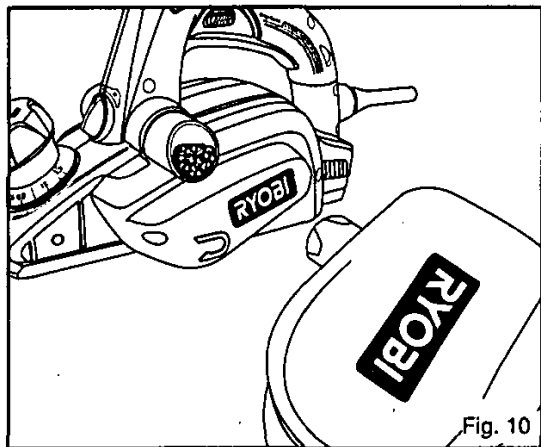
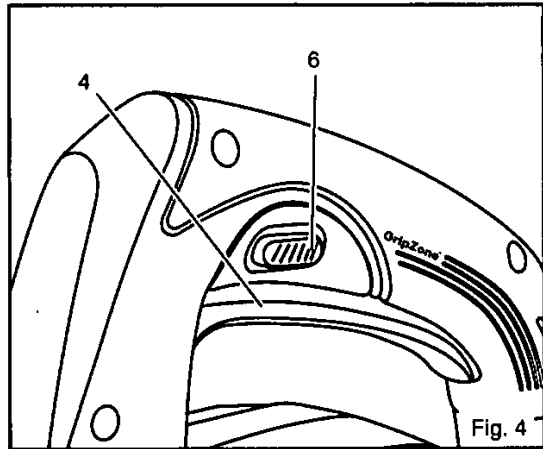
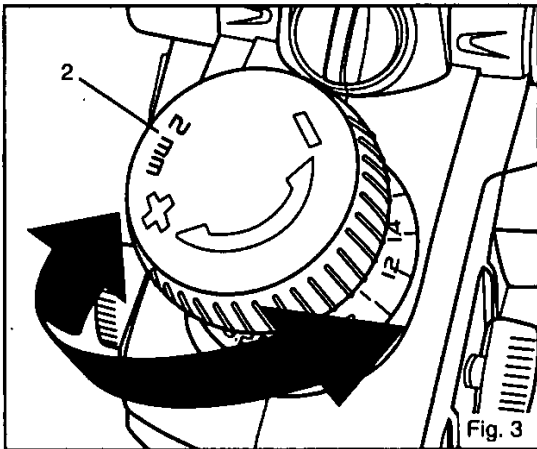
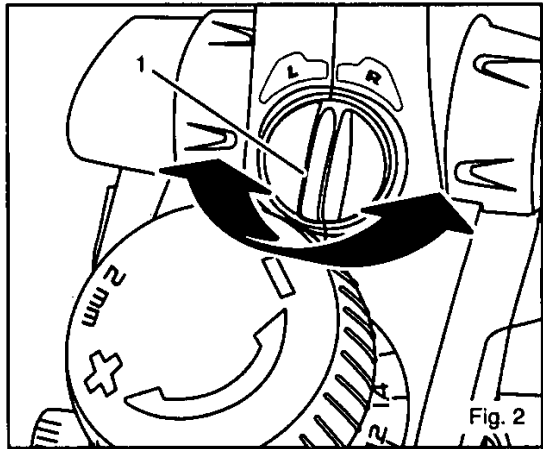
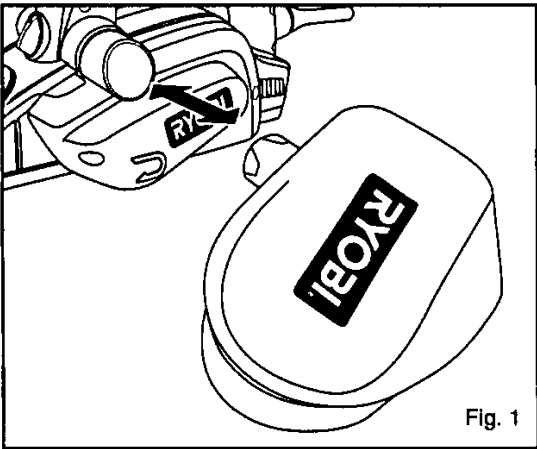
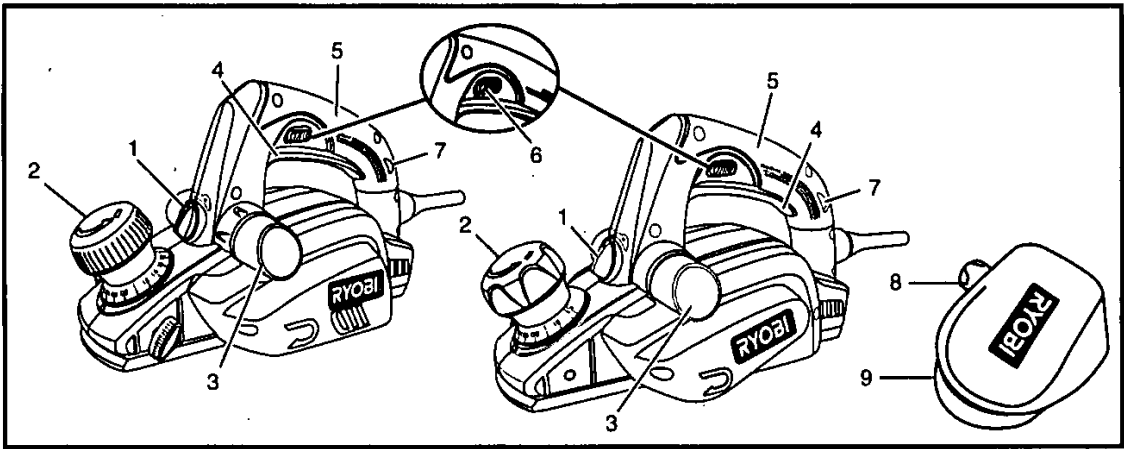

Fig. 10





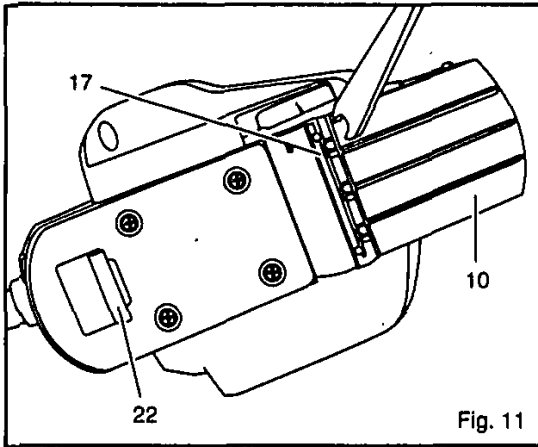

Fig. 11

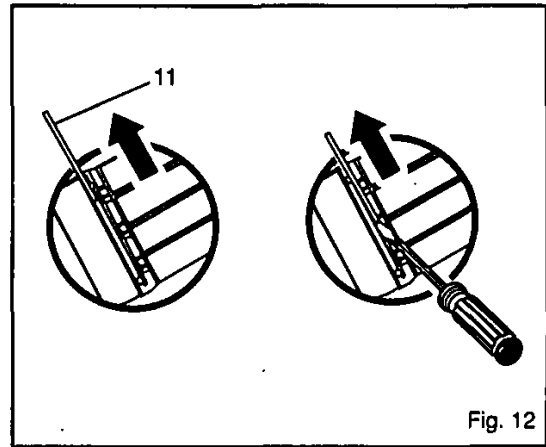

Fig. 12

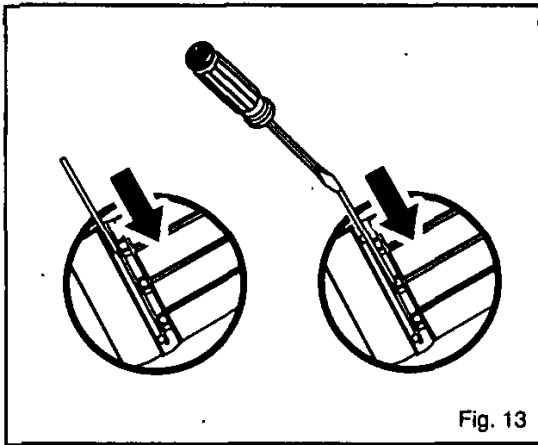

Fig. 13

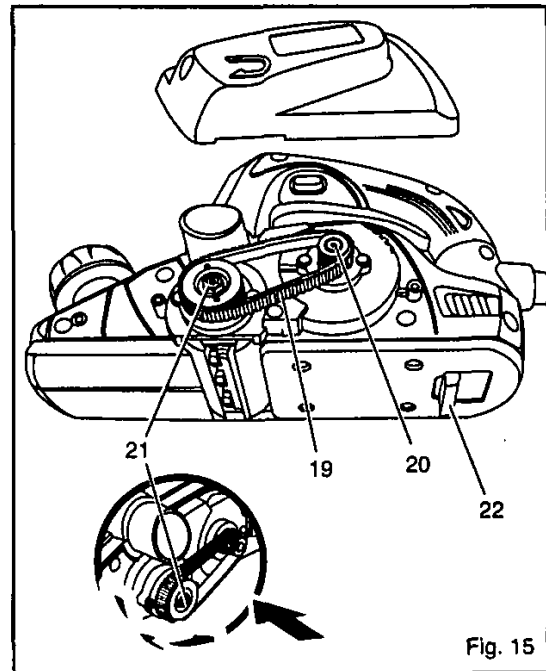

Fig. 15

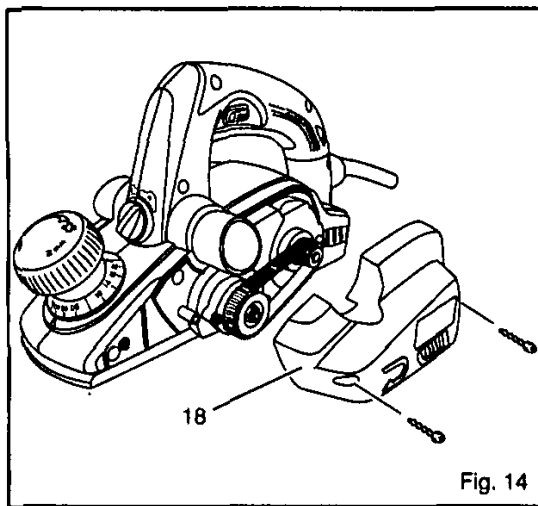

Fig. 14

## GENERAL SAFETY RULES

**WARNING!** Read all instructions. Failure to follow all instructions listed below may result in electric shock, fire and/or serious injury. The term "Power Tool" in all of the warnings listed below refers to your mains operated (corded) power tool or battery operated (cordless) power tool.



**SAFETY ALERT SYMBOL.** Indicates caution or warning. May be used in conjunction with other symbols or pictures.



**WARNING:** Failure to obey a safety warning can result in serious injury to yourself or to others. Always follow the safety precautions to reduce the risk of fire, electric shock and personal injury.



**WARNING:** Do not attempt to operate this tool until you have read thoroughly and understood completely safety rules etc. contained in this manual. Failure to comply can result in accidents involving fire, electric shock or serious personal injury. Save owners manual and review frequently for continuing safe operation and instructing others who may use this tool.



The operation of any tool can result in foreign objects being thrown into your eyes, which can result in severe eye damage. Before beginning power tool operation, always wear safety goggles or safety glasses with side shields and a full face shield when needed. We recommend Wide Vision Safety Mask for use over eyeglasses or standard safety glasses with side shields.

### WORK AREA

- **Keep work area clean and well lit.** Cluttered and dark areas invite accidents.
- **Do not operate power tools in explosive atmospheres, such as in the presence of flammable liquids, gases or dust.** Power tools create sparks which may ignite the dust or fumes.
- **Keep children and bystanders away while operating a power tool.** Distractions can cause you to lose control.

### ELECTRICAL SAFETY

- **Power tool plugs must match the outlet. Never modify the plug in any way. Do not use any adapter plugs with earthed (grounded) power**

**tools.** Unmodified plugs and matching outlets will reduce risk of electric shock.

- **Avoid body contact with earthed or grounded surfaces such as pipes, radiators, ranges and refrigerators.** There is an increased risk of electric shock if your body is earthed or grounded.
- **Do not expose power tools to rain or wet conditions.** Water entering a power tool will increase the risk of electric shock.
- **Do not abuse the cord.** Never use the cord for carrying, pulling or unplugging the power tool. Keep cord away from heat, oil, sharp edges or moving parts. Damaged or entangled cords increase the risk of electric shock.
- **When operating a power tool outdoors, use an extension cord suitable for outdoor use.** Use of a cord suitable for outdoor use reduces the risk of electric shock.

### PERSONAL SAFETY

- **Stay alert, watch what you are doing and use common sense when operating a power tool.** Do not use a power tool while you are tired or under the influence of drugs, alcohol or medication. A moment of inattention while operating power tools may result in serious personal injury.
- **Use safety equipment.** Always wear eye protection. Safety equipment such as dust mask, non-skid safety shoes, hard hat or hearing protection used for appropriate conditions will reduce personal injuries.
- **Avoid accidental starting.** Ensure the switch is in the off position before plugging in. Carrying power tools with your finger on the switch or plugging in power tools that have the switch on invites accidents.
- **Remove any adjusting key or wrench before turning the power tool on.** A wrench or a key left attached to a rotating part of the power tool may result in personal injury.
- **Do not overreach. Keep proper footing and balance at all times.** This enables better control of the power tool in unexpected situations.
- **Dress properly.** Do not wear loose clothing or jewellery. Keep your hair, clothing and gloves away from moving parts. Loose clothes, jewellery or long hair can be caught in moving parts.
- **If devices are provided for the connection of dust extraction and collection facilities, ensure these are connected and properly used.** Use of these devices can reduce dust related hazards.

## GENERAL SAFETY RULES

### POWER TOOL USE AND CARE

- **Do not force the power tool.** Use the correct power tool for your application. The correct power tool will do the job better and safer at the rate for which it was designed.
- **Do not use the power tool if the switch does not turn it on and off.** Any power tool that can not be controlled with the switch is dangerous and must be repaired.
- **Disconnect the plug from the power source before making any adjustments, changing accessories or storing power tools.** Such preventive safety measures reduce the risk of starting the power tool accidentally.
- **Store idle power tools out of the reach of children and do not allow persons unfamiliar with the power tool or these instructions to operate the power tool.** Power tools are dangerous in the hands of untrained users.
- **Maintain power tools.** Check for misalignment or binding of moving parts, breakage of parts and any other condition that may affect the power tools operation. If damaged, have the power tool repaired before use. Many accidents are caused by poorly maintained power tools.
- **Keep cutting tools sharp and clean.** Properly maintained cutting tools with sharp cutting edges are less likely to bind and are easier to control.
- **Use the power tool, accessories and tool bits etc., in accordance with these instructions and in the manner intended for the particular type of power tool, taking into account the working conditions and the work to be performed.** Use of the power tool for operations different from intended could result in a hazardous situation.

### SERVICE

- **Have your power tool serviced by a qualified repair person using only identical replacement parts.** This will ensure that the safety of the power tool is maintained.

### SPECIAL RULES

- **Wait for the cutter to stop before setting the tool down.** An exposed cutter may engage the surface leading to possible loss of control and serious injury.

## SPECIFICATION

	EPN-6082	EPN-7582N
Input :	230V ~ 50Hz	110V / 230V ~ 50Hz
Power :	600W	680W / 750W
No load speed :	16000 min <sup>-1</sup>	16000 min <sup>-1</sup>
Max. planing depth :	1.5 mm	2.0 mm
Max. planing width :	82 mm	82 mm
Max. rebate depth :	8 mm	12 mm
Net weight :	3.1 kg	3.2 kg

Be sure to check the nameplate on the product, because the voltage is subject to change depending on the area in which the product is to be used.

## DESCRIPTION

1. Exhaust direction knob
2. Depth adjust knob
3. Exhaust port
4. Trigger switch
5. Rear handle
6. Lock-off button
7. *Livetool indicator™*
8. Collar
9. Dust bag
10. Front shoe
11. Blade
12. Knob bolt
13. Bracket
14. Edge guide
15. Knob nut
16. Carriage head bolt
17. Blade holder
18. Belt cover
19. Belt
20. Small pulley
21. Large pulley
22. Kick stand

## FEATURES



### WARNING

If any parts are missing, do not operate your planer until the missing parts are replaced. Failure to do so could result in possible serious personal injury.

## FEATURES

### KNOW YOUR PLANER

Before attempting to operate your planer, familiarize yourself with all operating features and safety requirements. However, do not let familiarity with the tool make you careless.

Your planer is compact and lightweight. It is equipped with the following features:

#### SWITCH

The planer has a conveniently located trigger switch.

#### LOCK-OFF

The lock-off button locks the trigger switch in the OFF position when the trigger switch is released.



#### WARNING

Do not allow familiarity with your planer to make you careless. Remember that being careless a fraction of a second is sufficient time to inflict severe injury.

#### DEPTH ADJUSTMENT

Adjust the planing depth from 0 to 1.5 mm (EPN-6082) / 2.0 mm (EPN-7582N) in 0.2 mm increments and the last step meet to the maximum depth 1.5 mm (EPN-6082) / 2.0 mm (EPN-7582N).

#### KICK STAND (Fig. 11)

Your planer is fitted with an automatic retracting kick stand to prevent the blade from contacting the workbench on run down.

The kick stand will automatically retract as it passes over the edge of the workpiece when you commence planing operation.

#### EDGE/REBATE GUIDE

The edge guide included allows you to plane edges and make rebate cuts.

#### DUST BAG

The dust bag attaches to the planer and helps keep the work area free of dust and debris.

## ADJUSTMENTS



#### WARNING

The power planer should never be connected to a power supply when you are assembling parts, making adjustments, cleaning, performing maintenance or when the tool is not in use. Disconnecting the tool prevents accidental starting that could cause serious injury.

#### ATTACHING THE DUST BAG (Fig.1)

Follow these steps to attach the dust bag (9).

- Unplug the planer.
- Slide the collar (8) of the dust bag onto the dust port (3).

**NOTE:** To remove the dust bag, pull it straight out of the dust port.



#### CAUTION:

The dust bag fills quickly. Empty it often to prevent damage to the product.

#### ADJUSTING THE DUST DIRECTION (Fig.2)

Control the direction of debris when working in confined areas. Change the direction of the dust to either the right or left.

Follow these steps to adjust the dust direction.

- Unplug the planer.
- Adjust the dust direction and dust bag:
  - *To adjust dust to the right*—Move the dust direction knob (1) to the right and install the dust bag on the right dust port.
  - *To adjust dust to the left*—Move the dust direction knob to the left and install the dust bag on the left dust port.

#### ADJUSTING THE PLANING DEPTH (Fig.3)

Always work from a rough cut to a finish cut. The approximate setting for rough planing is 0.8 mm.

For finish planing use a setting of approximately 0.4 mm. Make test cuts in scrap wood after each adjustment to make sure that the planer is removing the desired amount of wood.

Follow these steps to adjust planing depth.

- Unplug the planer.
- Turn the depth adjustment knob (4) to the desired setting.

**NOTE:** To protect the blades during storage, transporting etc., set the depth adjustment to 0.



## OPERATION



### WARNING

Wait for the cutter to stop before setting the tool down. An exposed cutter may engage the surface leading to possible loss of control and serious injury.

### STARTING/STOPPING THE PLANER (Fig.4)

Follow these steps to start/stop the planer.

- To start the planer—Push the lock-off button (6) and then depress the trigger switch (4).
- The EPN-7582N is fitted with a feature known as soft start, this feature is electronically controlled and delays the start up of the motor and blades.
- To stop the planer—Release the trigger switch.

### PLANING (Fig.5)

Follow these steps to plane.

- Clamp the work securely.
- Adjust the planing depth. Refer to "Adjusting the Planing Depth" earlier in this manual.



### WARNING

Always use two hands on the tool for any operation; this assures that you maintain control and avoid risk of serious personal injury. Always properly support and clamp the work so that both hands are free to control the planer.

- Place the front shoe (10) on the edge of work to be planed.

**NOTE:** Make sure the blades (11) are not touching the work.

- Apply pressure to the front handle so that the front shoe is completely flat on the work.
- Start the planer and let the motor reach maximum speed.
- Hold the planer firmly and push it forward into the work, using a slow, steady motion.
- Apply downward pressure toward the rear handle as you reach the end of the planed cut. This helps keep the rear section of the planer base in contact with the work and prevents the front of the planer from gouging the cut.



### WARNING

Be careful to avoid hitting nails during planing operation; this action could nick, crack or damage blades.

**NOTE:** We suggest that you always keep an extra set of blades on hand. As soon as the blades in your planer show signs of becoming dull, replace them. The blades in your planer are reversible and can be reversed until both sides become dull.

### CHAMFERING (Fig.6)

The planer is designed with a chamfering groove in the front shoe to chamfer edges of boards as shown. Before making a cut on good timber, practice cutting on scrap lumber to determine the amount to be removed.

Follow these steps to chamfer.

- Clamp the work securely.
- Hold the front handle with your left hand and the rear handle with your right hand.
- Place the chamfering groove on the surface to be cut.
- Start the planer and let the motor reach maximum speed.
- Hold the planer firmly and push it forward into the work, using a slow, steady motion.
- Apply downward pressure to keep your planer flat at the beginning and the end of the work surface.

### PLANING EDGES AND MAKING REBATE CUTS

The planer comes with an adjustable edge guide for precision edge planing and rebate cutting. Attach the edge guide to the planer for planing edges and attach the edge guide to the left side for making rebate cuts.

### TO ATTACH THE EDGE GUIDE FOR PLANING EDGES (Fig.7)

Follow these steps to attach the edge guide for planing edges.

- Unplug the planer.
- Attach the bracket (13) to the planer using the knob bolt (12).
- Attach the edge guide (14) to the bracket using the knob nut (15) and the carriage head bolt (16).
- Tighten the retaining knob securely.

### TO PLANE EDGES (Fig.8)

Follow the directions in the "Planing" section earlier in this manual. Hold the edge guide firmly against the edge of the work surface.

## OPERATION

### TO ATTACH THE EDGE GUIDE FOR MAKING REBATE CUTS (Fig.9)

Follow these steps to attach the edge guide for making rebate cuts.

- Unplug the planer.
- Attach the bracket to the left side of the planer using the knob bolt.
- Attach the edge guide loosely to the bracket using the knob nut and the carriage head bolt.
- Adjust the edge guide to the desired width for the rebate cut.
- Tighten the retaining knob securely.

### TO MAKE REBATE CUTS (Fig.9)

Follow the directions in the "Planing" section earlier in this manual. Hold the edge guide firmly against the edge of the work surface.

The depth of the rebate is determined by the depth of the cut and the number of passes made along the work surface. The maximum depth of the rebate cut is 8.5 mm and has to be cut in 2.5 mm passes or less, to reach the desired depth. The width of the rebate cut is adjustable by moving the edge guide.



#### WARNING

Always wear safety goggles or safety glasses with side shields during power tool operation or when blowing dust. If operation is dusty, also wear a dust mask. Failure to do so could result in possible serious injury.

### CLEANING THE DUST PORT AND EMPTYING THE DUST BAG (Fig.10)

After using the planer for an extended period of time or when planing wet or green timber, chips may build-up in the dust port, and require cleaning. Chip build-up restricts air flow and causes the motor to overheat.

Clean the dust port and empty the dust bag regularly.

- Unplug the planer.



#### WARNING

Failure to unplug your planer could result in accidental starting causing serious injury.

- Remove the dust bag from the dust port.  
Clean the chip or dust build-up from the dust port of your planer with a small piece of wood. Do not use your hands or fingers.
- Empty all debris from the dust bag and ensure that the collar is free of debris.
- Replace the dust bag.

## MAINTENANCE



#### WARNING

When servicing, use only identical Ryobi replacement parts. Use of any other part may create a hazard or cause product damage.

## GENERAL

All parts represent an important part of the double insulation system and should be serviced only at an authorized service centre.

Avoid using solvents when cleaning plastic parts. Most plastics are susceptible to damage from various types of commercial solvents and may be damaged by their use. Use clean cloths to remove dirt, carbon dust, etc.



#### WARNING

Do not at any time let brake fluids, fuel, petroleum-based products, penetrating oils etc. Come in contact with plastic parts. They contain chemicals that can damage, weaken or destroy plastic.

Electric tools used on fiberglass material, wallboard, spackling compounds or plaster are subject to accelerated wear and possible premature failure because the fiberglass chips and grindings are highly abrasive to bearings, brushes, commutators etc. Consequently, we do not recommend using this tool for extended work on these types of materials. However, if you do work with any of these materials, it is extremely important to clean the tool using compressed air.

## LUBRICATION

All of the bearings in this tool are lubricated with a sufficient amount of high-grade lubricant for the life of the unit under normal operating conditions. Therefore, no further lubrication is required.

## MAINTENANCE

### REPLACING BLADES (Fig.11,12 & 13)

The blades (11) in your planer are reversible. Therefore, you can reverse the blades when one edge becomes dull. Always replace or reverse blades in pairs. Do not attempt to sharpen blades. If the blades become dull, replace them.

When replacing the blades, use recommended replacement blade only.



#### WARNING

Blades are sharp, use extreme caution when replacing the blades. Failure to heed this warning can result in serious personal injury.

- Unplug the planer.



#### WARNING

Failure to unplug the planer could result in accidental starting causing serious injury.

- Secure the planer in an upside down position.
- Loosen the three screws securing the blade on the blade holder (17) using the blade wrench provided.

**NOTE:** Do not over-loosen the screws. If screws are too loose, alignment of the new blade will not be accurate.

**NOTE:** Before removing the old blades, take notice of the direction of cut as well as how the tapered edge of the old blades are oriented. The tapered edge of the new blades must be in the same orientation as the original blades.

- Push the blade (to the right) out of the blade holder using the tip of a screwdriver.
- Remove the old blade from the blade holder.

**NOTE:** If the blade can not be easily pushed out of blade holder after loosening blade securing screws, use a block of wood to break the blade loose from the blade holder, with a short sharp blow. Then push the blade with a screwdriver to remove. If necessary, tap the block of wood sharply with a small hammer to break the blade loose.

- Clean any sawdust or wood chips from around the blade area.
- Slide the new blade into the slot of the blade holder.
- Use a screwdriver to push the blade into the blade holder until it is centered into position.
- Retighten the three blade securing screws using the blade wrench.
- Repeat the above procedure to change the other blade.

### REPLACING THE BELT (Fig.14 & 15)

When replacing the belt, use the recommended replacement belt only.

- Unplug the planer.



#### WARNING

Failure to unplug the planer could result in accidental starting causing serious injury.

- Remove belt cover (18) screws.
- Remove the belt cover.
- Force the old belt from the small pulley (20) by turning in the direction shown. As you turn the belt (19), pull and work it off the small pulley until it has been completely removed from both pulleys.
- Install the new belt over the large pulley (21). As you turn the belt, push and work it onto the small pulley until it is in place.
- Replace the belt cover.
- Install belt cover screws and tighten securely, but do not overtighten.

**NOTE:** Do not overtighten the screws.

## LIVE TOOL INDICATOR

This tool features a live tool indicator (7) which illuminates as soon as the tool is connected to the supply. This warns the user that the tool is connected and will operate when the switch is pressed.

## ENVIRONMENTAL PROTECTION



Do not dispose of in general household waste. Instead, dispose in an environmentally friendly way. Contact your local recycling centre or council for advice. Ryobi takes the care of the environment very seriously.

## GUARANTEE - STATEMENT

This product is guaranteed from defects in material and workmanship, for a period of 24 months, effective and evidenced from date of original invoice or delivery note.

Defects caused by normal wear and tear, unauthorized / improper maintenance/handling or overload are excluded from this guarantee as are accessories such as battery packs, bulbs, blades and bits, etc.

In the event of malfunction within the guarantee period, please return the product **UNDISMANTLED** with proof of purchase, to your dealer or nearest Ryobi Service Centre.

Your statutory rights in respect of defective products remain unaffected by the warranty

### DECLARATION OF CONFORMITY

We declare under our sole responsibility that this product is in conformity with the following standards or standardized documents.

**89/336/EEC, 98/37/EC, 73/23/EEC, 93/68/EEC.**

**EN 50366**

**EN 55014-1**

**EN 55014-2**

**EN 61000-3-2**

**EN 61000-3-3**

**EN 60745-1**

**EN 60745-2-14**

**Sound Pressure level:**

**Sound Power level:**

**Vibration level:**

**EPN-6082**

**84.4+3 dB(A)**

**95.4+3 dB(A)**

**1.86 m/s<sup>2</sup>**

**EPN-7582N**

**87.8+3 dB(A)**

**98.8+3 dB(A)**

**1.89 m/s<sup>2</sup>**

Machine: **PLANER**

Type: **EPN-6082, EPN-7582N**

**CE 01.08.2006**

Name of company: **Ryobi Technologies (UK) Ltd.**

Address:

**MEDINA HOUSE  
FIELD HOUSE LANE  
MARLOW  
BUCKS, SL7 1TB  
UNITED KINGDOM  
Tel:+44-1628-894400  
Fax:+44-1628-894401**

Name/Title:

**Mark Pearson  
Managing Director**

Signature:

