

Installation instructions and manual for the electronic clock thermostat
Type FHT

General information:

The FHT is designed specially for electrical floor heating. The floor sensor is supplied standard with the system. Always switch off the power before installation or removal.

The connection should always be carried out by a qualified electrician according to the local instructions. Please study these guidelines with caution before installation and use.

Save these instructions carefully for possible later use.

Direction for use: Turn on the power after having checked the installation instructions carefully. In the screen the present room temperature and 12.00h will appear flashing.

The thermostat is operated with the use of three buttons:

- Left: Note the signs, higher or lower
- Middle: SET: menu choice and confirmation
- Right: Note the signs, higher or lower

Menu

At the bottom appears "SET" above the middle button and by pressing this, the menu will appear.

The menu is made up from:

- Day/Time Setting right day and time
- Program Change standard week program
- Temperature Adjustment standard setting
- On/Off On/Off
- Auto/Man Automatic or manual

Start:

Setting day and time

1. Press the middle button twice
 2. First confirm Day/Time with the middle button
 3. Set the day on the top and confirm
 4. Wait until hour flashes. Set the correct hour and confirm
 5. Wait until minute flashes. Set the right minutes and confirm
- Almost immediately automatic will appear in the main screen.

After the setting of the correct day and time:

The thermostat is now operative following to the standard program. You can recognise this from the blinking of the two dots between the hour and the minutes in the main screen. Please do not change this program during the first week so the thermostat can store historical data. When power is consumed the word HEATING will appear on the screen. If not the thermostat is functioning on stand-by.

In the menu the settings you will find underneath are pre-programmed. These settings can be adjusted by going into the menu by pressing SET, select the relevant topic, confirming this and then adjusting this with the left or right button. Do not forget to confirm all steps with the middle button. After the last confirmation the main screen will appear again.

Incorrect settings can be reset in the same way.

RESET: (return to standard settings):

Choose Auto/Man and press the right button for approx. 5 seconds.

Program Confirm and adjust standard settings of: Mo to Fri from 5.00h to 9.00h and from 17.00h to 23.00h. Sa / Sun from 9.00h to 23.00h.

Temperature Adjust comfort temperature and confirm. Night set back will show. Adjust as below. The difference can be approx. 3°C for main heating and 5°C max. for side heating. For example: if you set a comfort temperature of 21°C for side heating, the set back temperature should not be lower than 16°C.

On/Off Confirm and adjust standard setting On to Off or vice versa.

Auto/Man Confirm and adjust standard setting Auto to Man or vice versa.

Childproof lock

When desirable a childproof lock can be installed by pressing the middle button for approx. 8 seconds. A small lock will appear in the top right of the screen. This lock can be turned off by pressing the middle button for 8 seconds.

Error messages when failure occurs:

When the following codes appear on the screen, first contact your supplier.

- F1 = Sensor failure
- F2 = Power failure
- F3 = Memory failure

The adjustments below should be carried out after consultation with your supplier.

Choose Auto/Man in the menu and press the left button for approx. 5 seconds. You now enter the service menu which is only intended for the installer.

- 1 = With the flashing number you can adjust the screen contrast.
- 2 = Press SET – with the flashing number you can now adjust the calibration.
- 3 = Press SET – with the flashing number you can now adjust the differential.
- 4 = Press SET and the software number appears on the screen.

To return to the main screen press SET

Direction for the installer:

Check before installation the power is off. Remove the cover and protection cap by carefully taking them off together.

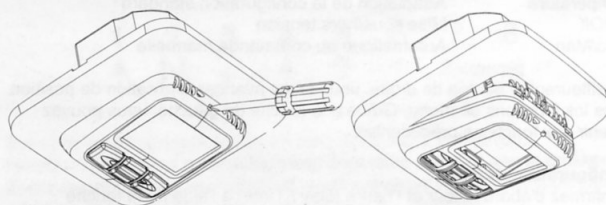

Connect the sensor, power and power supply cables according to the wiring diagram.

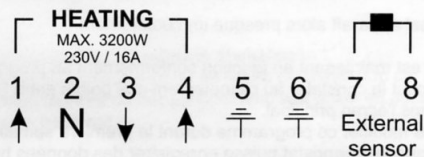

Place the thermostat in the right position and fasten this with two screws. Replace the cover and protection cap by pressing them softly. As soon as the power is turned back on 12.00 will appear flashing and the thermostat can be used.

In case of a newly installed floor, allow at least three weeks drying out periods.

Technical data:

- Power supply 230V / 16 Amp
- Max. capacity 3200W
- Temperature range 5°C to 40°C
- Class IP20
- Colour RAL9010 – Polar/White
- Warranty 2 years
- Examination CE

Manufacturer:
Cleophas & Fiebig Technieken BV
Tholen – The Netherlands