

# Erbauer®

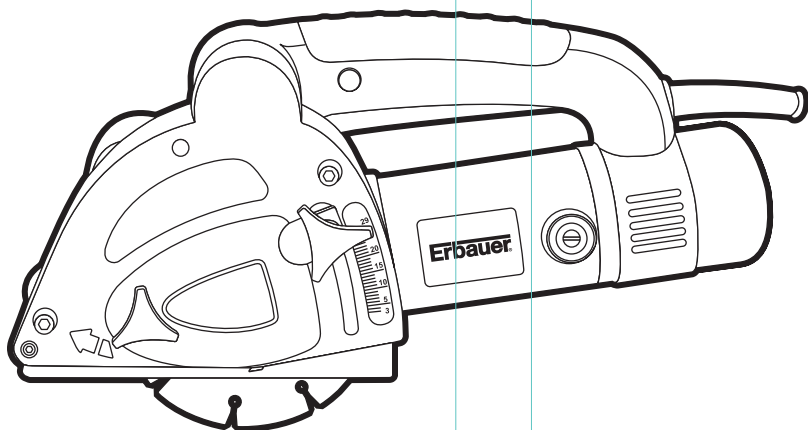

**ERB125Y**

**2** WARRANTY  
**YEARS**

**1500W WALL CHASER**

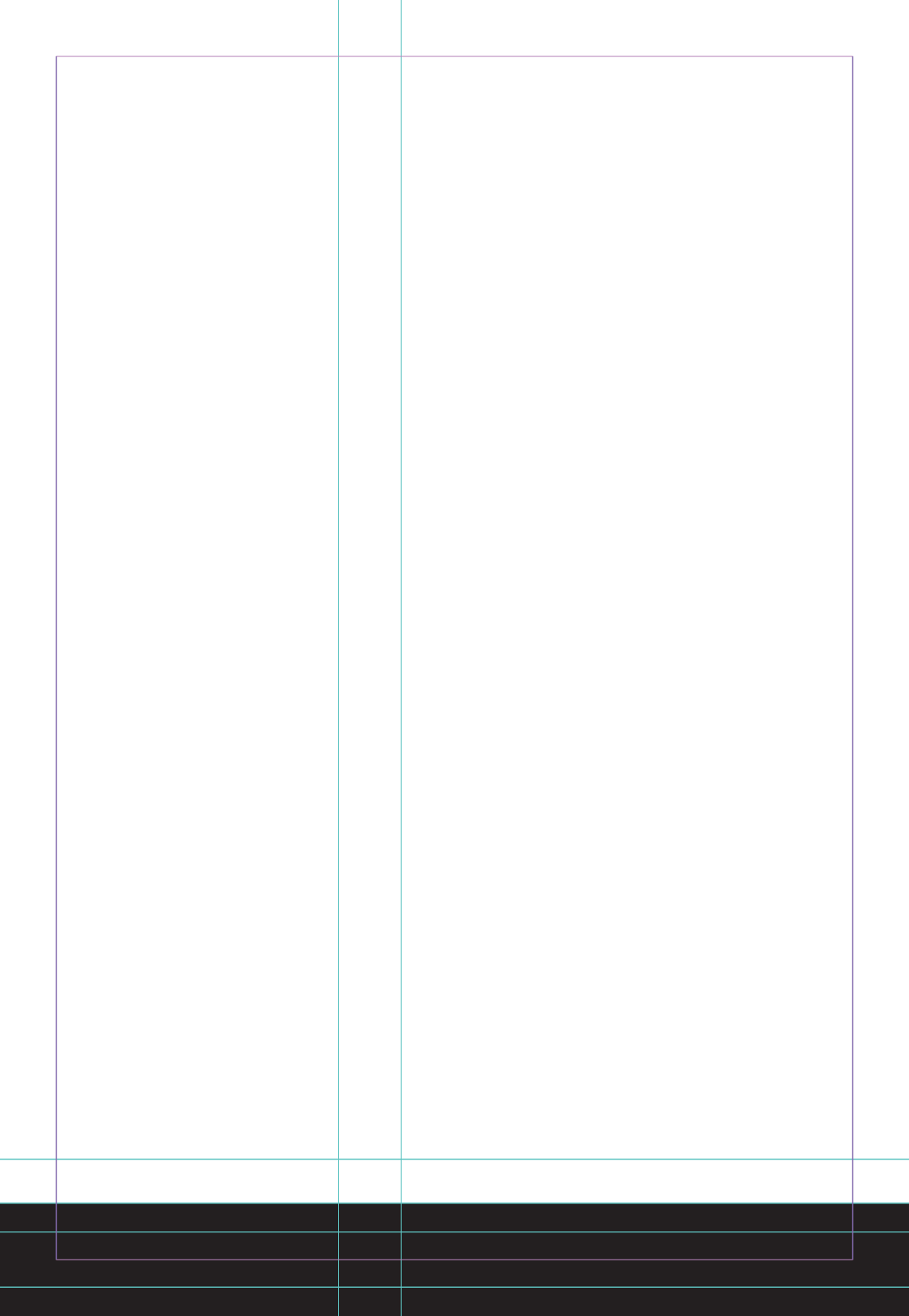

# Erbauer®

**Congratulations on your purchase of a quality power tool from Screwfix Direct Ltd. This product should give you reliable service but for your peace of mind this Erbauer power tool does carry a 24-month guarantee, the terms of which are detailed below.**

**If this product develops a fault within the guarantee period contact Screwfix Direct Ltd on Freephone 0500 41 41 41.**

**Please retain this handbook in case you need to refer to safety, care or guarantee information in the future.**

## **GUARANTEE**

This Erbauer product carries a Screwfix Direct Ltd guarantee of 24 months. If your product develops a fault within this guarantee period, you should in the first instance contact Screwfix Direct Ltd on Freephone 0500 41 41 41. If the fault occurs within the first 24 months, you may return the goods for a full refund or we will repair or replace the goods if you prefer. When repair is not practical or identical goods are not available, alternative goods of similar specification and quality will usually be provided but, failing this, you will be offered a partial or full refund depending on the time period since purchase.

This guarantee specifically excludes losses caused due to:

- Fair wear and tear
- Misuse or abuse
- Lack of routine maintenance
- Failure of consumable items (such as batteries)
- Accidental damage
- Cosmetic damage
- Failure to follow manufacturer's guidelines
- Loss of use of the goods
- Repairs attempted by anyone, unless authorised by Screwfix Direct Ltd.

This guarantee does not affect your statutory rights. This guarantee is only valid in the UK.

For further technical advice, spare parts or repair service (outside of guarantee) please contact the customer helpline number on 0845 607 6380.

**1500W WALL CHASER**

# SAFETY INSTRUCTIONS



**WARNING!** Read all instructions. Failure to follow all instructions listed below may result in electric shock, fire and/or serious injury.

SAVE THESE INSTRUCTIONS

## 1. Work area.

**a. Keep work area clean and well lit.** Cluttered and dark areas invite accidents.

**b. Do not operate power tools in explosive atmospheres, such as in the presence of flammable liquids, gases or dust.** Power tools create sparks which may ignite the dust or fumes.

**c. Keep children and bystanders away while operating a power tool.** Distractions can cause you to lose control.

## 2. Electrical safety.

**a. Power tool plugs must match the outlet. Never modify the plug in any way. Do not use any adapter plugs with earthed (grounded) power tools.** Unmodified plugs and matching outlets will reduce risk of electric shock.

**b. Avoid body contact with earthed or grounded surfaces such as pipes, radiators, ranges and refrigerators.** There is an increased risk of electric shock if your body is earthed or grounded.

**c. Do not expose power tools to rain or wet conditions.** Water entering a power tool will increase the risk of electric shock.

**d. Do not abuse the cord. Never use the cord for carrying, pulling or unplugging the power tool. Keep cord away from heat, oil, sharp edges or moving parts.** Damaged or entangled cords increase the risk of electric shock.

**e. When operating a power tool outdoors, use an extension cord suitable for outdoor use.** Use of a cord suitable for outdoor use reduces the risk of electric shock.

**f. Use a Residual Circuit Breaker on all 230V Power tools.** This can help minimise the risk of an electrical shock if an earth fault or short circuits occurs.

**g. If using a power cable extension ensure that the cable is fully unwound and that its length is less than 30m.** Lengths over 30 m will effect the tools performance as a result of voltage drop.

## 3. Personal safety.

**a. Stay alert, watch what you are doing and use common sense when operating a power tool. Do not use a power tool while you are tired or under the influence of drugs, alcohol or medication.** A moment of inattention while operating power tools may result in serious personal injury.

**b. Use safety equipment. Always wear eye protection.** Safety equipment such as dust mask, non-skid safety shoes, hard hat, or hearing protection used for appropriate conditions will reduce personal injuries.

**c. Avoid accidental starting. Ensure the switch is in the off-position before plugging in.** Carrying power tools with your finger on the switch or plugging in power tools that have the switch on invites accidents.

**d. Remove any adjusting key or wrench before turning the power tool**

**on.** A wrench or a key left attached to a rotating part of the power tool may result in personal injury.

**e. Do not overreach. Keep proper footing and balance at all times.** This enables better control of the power tool in unexpected situations.

**f. Dress properly. Do not wear loose clothing or jewellery. Keep your hair, clothing and gloves away from moving parts.** Loose clothes, jewellery or long hair can be caught in moving parts.

**g. If devices are provided for the connection of dust extraction and collection facilities, ensure these are connected and properly used.** Use of these devices can reduce dust-related hazards.

#### **4. Power tool use and care.**

**a. Do not force the power tool. Use the correct power tool for your application.** The correct power tool will do the job better and safer at the rate for which it was designed.

**b. Do not use the power tool if the switch does not turn it on and off.** Any power tool that cannot be controlled with the switch is dangerous and must be repaired.

**c. Disconnect the plug from the power source before making any adjustments, changing accessories, or storing power tools.** Such preventive safety measures reduce the risk of starting the power tool accidentally.

**d. Store idle power tools out of the reach of children and do not allow persons unfamiliar with the power tool or these instructions to operate the power tool.** Power tools are dangerous in the hands of untrained users.

**e. Maintain power tools. Check for misalignment or binding of moving parts, breakage of parts and any other condition that may affect the power tools operation. If damaged, have the power tool repaired before use.** Many accidents are caused by poorly maintained power tools.

**f. Keep cutting tools sharp and clean.** Properly maintained cutting tools with sharp cutting edges are less likely to bind and are easier to control.

**g. Use the power tool, accessories and tool bits etc., in accordance with these instructions and in the manner intended for the particular type of power tool, taking into account the working conditions and the work to be performed.** Use of the power tool for operations different from intended could result in a hazardous situation.

#### **5. Service.**



**a. Have your power tool serviced by a qualified repair person using only identical replacement parts.** This will ensure that the safety of the power tool is maintained.

#### **HEALTH ADVICE**



**WARNING!** When drilling, sanding, sawing or grinding, dust particles will be produced. In some instances, depending on the materials you are working with, this dust can be particularly harmful to you (e.g. lead from old gloss paint).

# **1500W WALL CHASER**

You are advised to consider the risks associated with the materials you are working with and to reduce the risk of exposure. You should:

- Work in a well-ventilated area.
- Work with approved safety equipment, such as those dust masks that are specially designed to filter microscopic particles.

## **ADDITIONAL SAFETY INSTRUCTIONS FOR YOUR WALL CHASER**

### **1. Maintain the tool with care**

- 1) Keep cutting equipment sharp and clean, so you will achieve a good result, safely.
- 2) Follow the directions for lubrication and replacement of parts.
- 3) Inspect the power cord regularly and have a damaged cord repaired by an authorized service agent.
- 4) Inspect extension cords regularly, and replace any damaged cords.
- 5) Keep handgrips dry, clean and free from grease and oil.

### **2. Remove adjustment tools and spanners**

Make it a habit to never switch on the machine, until you have checked that any adjusting tools or spanners have been removed.

### **3. Avoid unintentional starting**

Never carry a connected machine with a finger on the switch. Make certain that the switch is in the "OFF" position, before connecting the machine to the power supply.

### **4. Use outdoor extension cords**

Whenever you use the tool outdoors, always use extension cords specifically designed for outdoor use.

### **5. Stay alert**

Watch what you are doing. Use your common sense. Do not use the tool when you are tired.

### **6. Inspect damaged parts**

- 1) Before making further use of the tool, if any safety feature such as a protective cover or other part has been damaged, make absolutely certain that the machine is still safe to use, and that the part can still perform its protective function.
- 2) Check the alignment and free movement of moving parts, possible breakage of parts, attachments and any irregularities that could adversely affect operation.
- 3) A safety cover or any other damaged part should be properly repaired or replaced by an authorized service agent, unless otherwise directed in these directions.
- 4) Have any defective switches replaced by an authorized service agent.
- 5) Never use the tool whenever the tool cannot be switched "ON" or "OFF" with its own switch.

## 7. Caution

- 1) Use of any part or accessory, other than described in these instructions for use, may possibly lead to bodily injury.
- 2) Do not use blades which are deformed or cracked.
- 3) Do not use blades made of high speed steel.
- 4) Do not stop to use the blades by lateral pressure on the disc.
- 5) Remove plug from the mains supply before replacement of the blade, making adjustments, or other maintenance work.
- 6) Using manufacturer data.



## 8. Warning!

Always use the appropriate safety equipment that is required for the product. e.g. Goggles/Safety Spectacles, Ear defenders (essential with tools with a noise rating of over 85dB(A)), Gloves and face masks, in all cases ensure that the safety equipment is in good condition !



Warning! Never drill, cut or chase in surfaces, in which electrical cabling, gas or water pipes could be concealed. Always use a suitable detector to seek out concealed wiring or piping, or obtain advice from the local energy or water company.

## Double insulation:

The tool is double insulated. This means that all the external metal parts are electrically insulated from the mains power supply. This is done by placing insulation barriers between the electrical and mechanical components making it unnecessary for the tool to be earthed.

## Important note:

Remove the main plug from socket before carrying out any adjustment or servicing. Ensure your mains supply voltage is the same as your tool rating plate voltage.

## SYMBOLS



Read the manual



Warning



Wear gloves



Wear dust mask, eye & ear protection



Conforms to relevant safety standards

# 1500W WALL CHASER

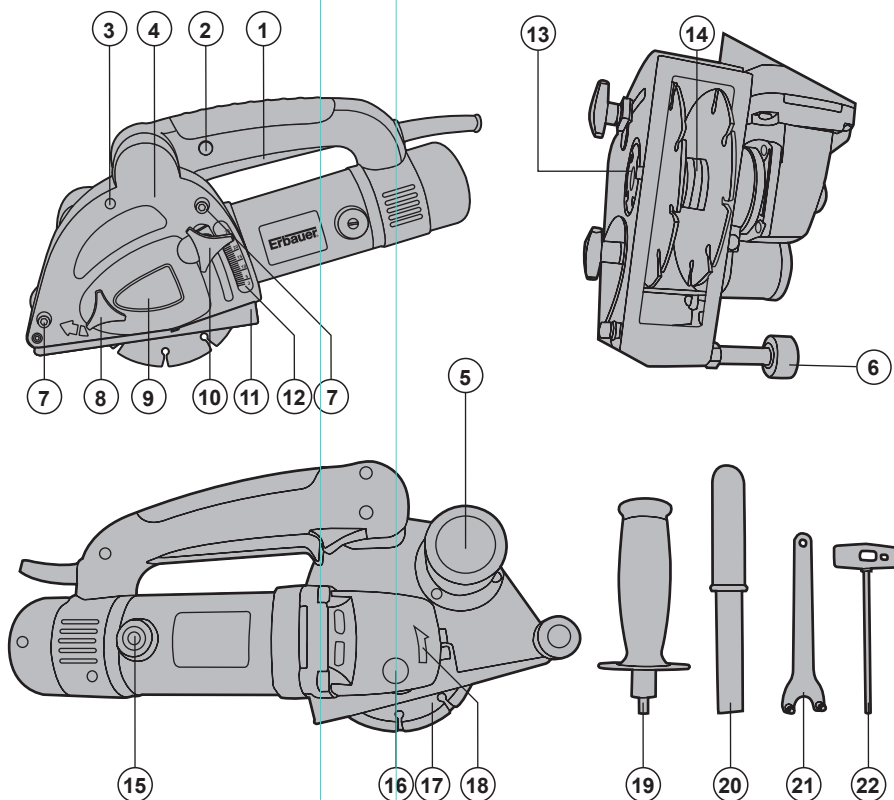

**Fig 1**

**1 ON/ OFF TRIGGER SWITCH**

**2 'LOCK OFF' BUTTON**

**3 ATTACHMENT POINT FOR AUXILIARY HANDLE**

**4 FIXED GUARD**

**5 CONNECTION TO DUST EXTRACTION**

**6 GUIDE WHEEL**

**7 BOLT FOR FIXING GUARD**

**8 FLANGE CAP LOCK KNOB**

**9 FLANGE CAP**

**10 ADJUSTING CHANNEL DEPTH KNOB**

**11 BASE PLATE**

**19**

**20**

**21**

**22**



<b>12 CHANNEL DEPTH SCALE</b>
<b>13 OUTER FLANGE</b>
<b>14 DISTANCE WASHERS</b>
<b>15 CAP OF CARBON BRUSH (ON BOTH SIDES)</b>
<b>16 SPINDLE LOCKING BUTTON</b>
<b>17 DIAMOND CUTTING DISC</b>
<b>18 CUTTING DIRECTION ARROW</b>
<b>19 AUXILIARY HANDLE</b>
<b>20 CHISEL</b>
<b>21 SPANNER</b>
<b>22 ALLEN KEY</b>

## TECHNICAL DATA

Voltage:	230V~50Hz
Power Input:	1500W
No Load Speed:	8500min <sup>-1</sup>
Cutting Width:	8-30mm
Cutting Depth:	5-30mm
Blade size:	Ø125mmx2.2mmxØ22.2mm
Double insulation:	<input type="checkbox"/>
Weight:	5.0Kg

## NOISE AND VIBRATION DATA

Sound pressure level:	98.5 dB (A)
Sound power level:	109.5dB (A)
Vibration level:	<3.844 m/s <sup>2</sup>

## ACCESSORIES

<b>Chisel:</b>	<b>1pc</b>
<b>Diamond blades</b>	<b>2pcs</b>
<b>Carbon brushes</b>	<b>2pcs</b>
<b>Auxiliary handle</b>	<b>1pc</b>
<b>Allen key</b>	<b>1pc</b>

# 1500W WALL CHASER

# OPERATION INSTRUCTIONS

**⚠ WARNING**  
Before using your wall chaser be sure to read this instruction manual carefully!  
**NEVER** press the spindle locking button while the machine is running.  
**ALWAYS** unplug the tool from the power supply **BEFORE** carrying out any adjustments or maintenance.

**Fig 2**

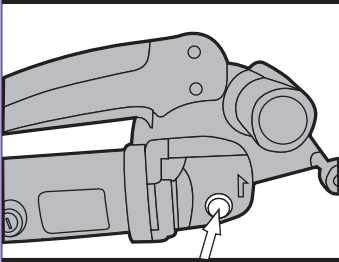

**Fig 3**

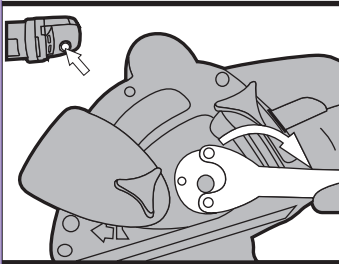

**Fig 4**

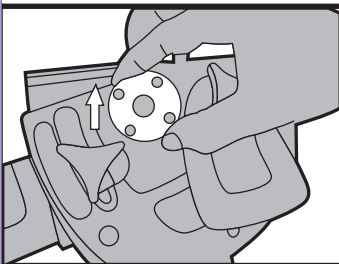

**Fig 5**

## 1. Fitting Cutting Discs

**⚠ CAUTION**  
Use only diamond cutting discs suitable for the material to be cut.  
This tool is designed to cut such materials as reinforced concrete and masonry without the use of water.

Firstly loosen the adjusting channel depth knob and then loosen the flange cap lock knob. You can now slide the flange cap up and reveal the flange.(see fig 2)

Using the spanner provided you can undo the flange, at the same time depress the spindle-locking button.(see fig 3&4)

**⚠ NOTE:** This is a left hand thread therefore turn the spanner **CLOCKWISE**.

Completely remove the flange and the distance washers.

**⚠ IMPORTANT NOTE:** There is one rubber 'transit' washer fitted, remove and aside this prior to fitting the cutting blades **DO NOT USE** these during normal operation.

Now assemble the blades and distance washers to suit your application.(see fig5&6)

## 2. Adjusting the groove width

You can adjust the groove width (the distance between the two diamond wheels) by simply changing the distance washer position as shown in the table below:

## Adjusting the groove width (the distance between the two diamond wheels)

The width of grooving in the workpiece can be adjusted by changing the number of the space rings as shown in the table

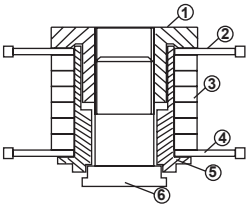
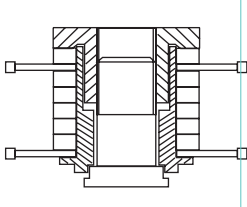
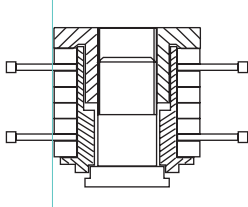
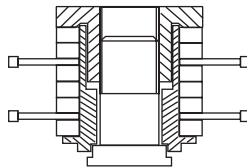
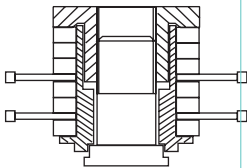
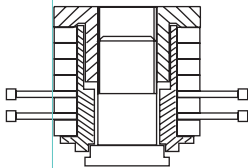
Groove width:29.8mm	Groove width:25.5mm	Groove width:21.2mm
		
Groove width:16.9mm	Groove width:12.6mm	Groove width:8.3mm
		

- 1.outer flange    2.diamond wheel    3.distance washers  
4.diamond wheel    5.support flange    6.drive spindle

Once you have determined your optimum groove width carefully mount a diamond wheel to the spindle, then mount the distance washers and second diamond wheel as appropriate.(see fig7&8)

**CAUTION:** The support flange must always be located to the drive spindle and should not be free to rotate, make sure it is fully located prior to loading the disc's and distance washers!

**NOTE:** Always make sure that you have mounted the wheels correctly and in accordance with the direction arrows on the diamond disc and the body of the machine.(see fig 9)

Now mount the outer flange and tighten using the spanner provided, again note that this is a LEFT HAND thread so tighten in an anti-clockwise direction. At the same time depress the spindle-locking button.(see fig10&11)

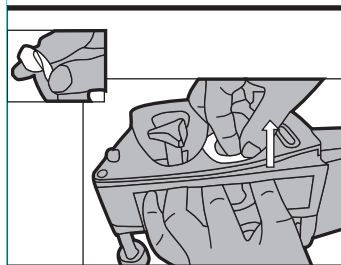

Fig 6

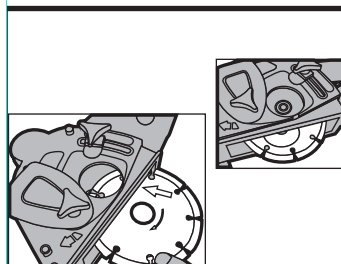
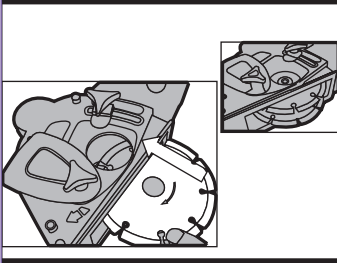
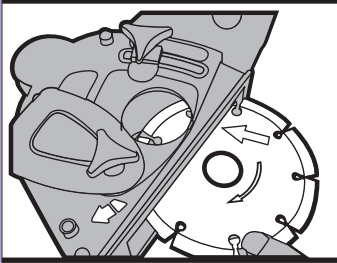

Fig 7



**Fig 8**



**Fig 9**

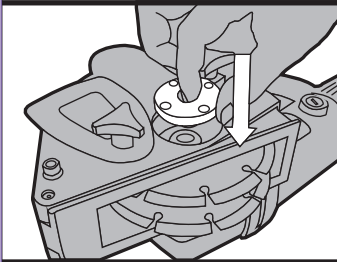

**Fig 10**

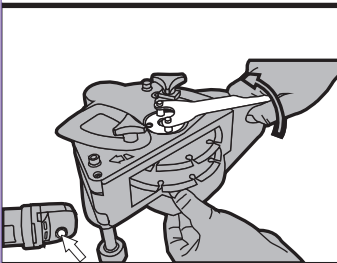

**Fig 11**

Finally lower the flange cap and re-tighten the flange cap lock knob and the adjusting channel depth knob.(see fig12)

### **3. Adjusting the groove depth**

You can adjust the depth of groove simply by loosening the adjusting channel depth knob and lowering or raising the base plate to the desired position .

Re tighten the adjusting channel depth knob after setting the depth.(see fig13,14&15)

### **4. Removing the Fixed guard (Alternative blade fixing method)**

In order to clean the internal guard area from debris you can remove the fixed guard and gain access to the internal cutting head area.

Firstly completely unscrew and remove the adjusting channel depth knob and its sight marker,now using the Allen key supplied undo the two guard fixing bolts and lift off the fixed guard.

The base plate can also be removed by sliding it off the guide wheel pin.

This method can also be used to fix and adjust the cutting blades.

To re- assemble simply reverse the above procedure.(see fig 16,17,18,19,20,21,22,23,24&25)

### **5. Fitting the auxiliary handle**

For your own safety we recommend that you fit the auxiliary handle at all times thus maintaining complete control of the tool during operation.

To fit the handle locate to the fixed guard and simply screw into place and secure.(see fig26)

### **6. Connecting the Dust extraction adaptor**

Your wall chaser is fitted with a dust extraction adaptor.

This has a bayonet joint that will prevent it from unintentional loosening during operation.

Locate the extraction hose into the adaptor and ensure it is securely located.

We recommend that you use a suitable dust extraction method at all times and this will prevent the build up of debris and possible overheating of the motor!( see fig 27)

### **7. Switching ON and OFF**

The machine is equipped with a safety lock off

button to prevent unintentional starting.  
To switch on simply depress the safety lock of button and then depress the ON/OFF trigger.  
To switch off release the ON/OFF trigger.(see fig 28)

### 8. Using the Tool

The machine can be used to cut grooves (Channels) in all manner of materials. Concrete, masonry and paving for example. Without the use of water.

**⚠ WARNING**  
BEFORE you start work ensure that the area is clear of electric cables, gas and water pipes.

Bring the wall chaser into contact with the wall, firstly switch on and bring the motor up to speed.

Slowly push down until the preset depth of cut is achieved.

Now pull the chaser in the direction of the cut, for example from top to bottom.

The material that remains between the two cuts can be cleared using the chisel supplied.

**⚠ NOTE: Deep cuts into hard materials cannot be achieved in a single cut!**

### 9. Replacing the Carbon Brushes (see fig 29)

If you suspect that the brushes may be worn or as a purely precautionary measure, the brushes can be removed and inspected and replaced if required.

Firstly completely undo the cap over the brush housing.

You can now remove the carbon brush from its housing.

Check the length and replace in under 7 mm.

Always replace brushes in pairs.

Slide the new brush into the housing and re-locate the cap and secure.

Once both brushes have been replaced check and confirm that the chaser still operates

Allow the unit to run for a few minutes to enable the new brushes to 'bed' down.

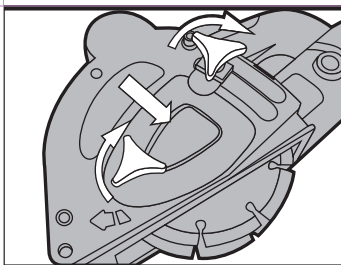

Fig 12

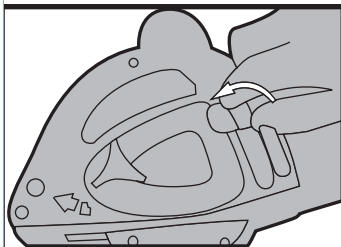

Fig 13

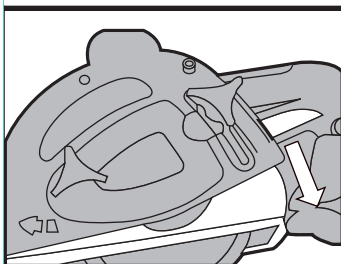

Fig 14

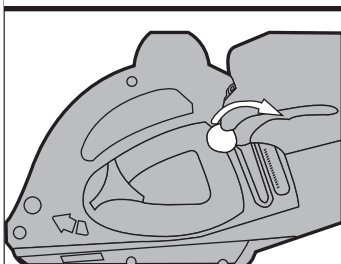
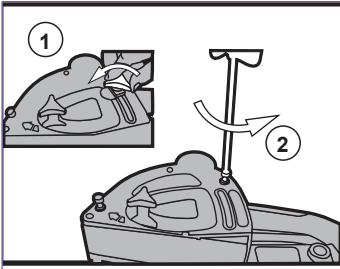
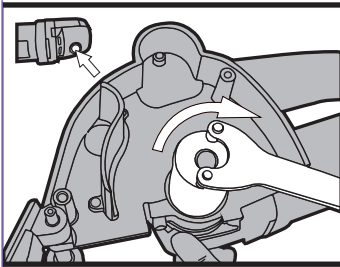

Fig 15



**Fig 16**



**Fig 17**

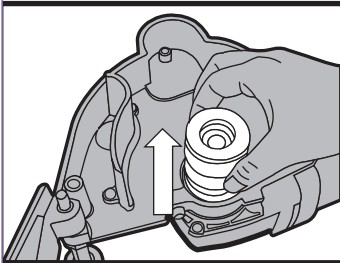

**Fig 18**

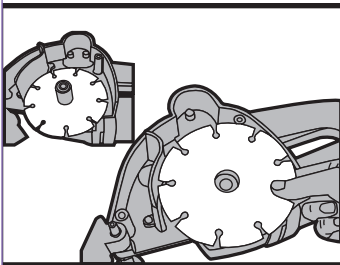

**Fig 19**

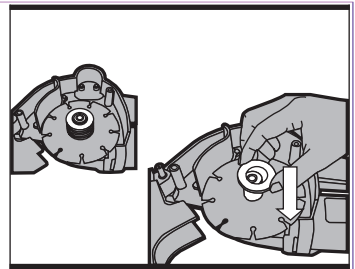

**Fig 20**

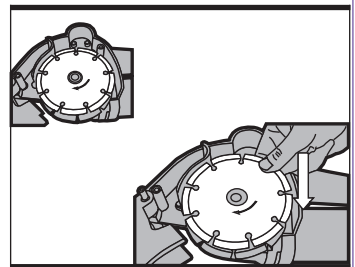

**Fig 21**

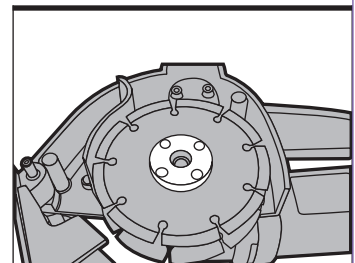

**Fig 22**

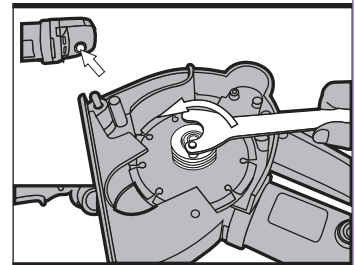

**Fig 23**

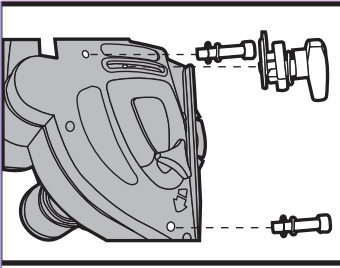

**Fig 24**

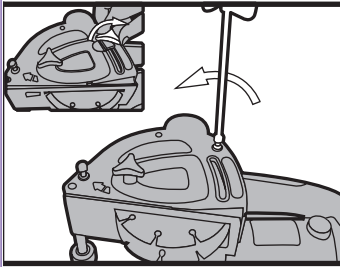

**Fig 25**

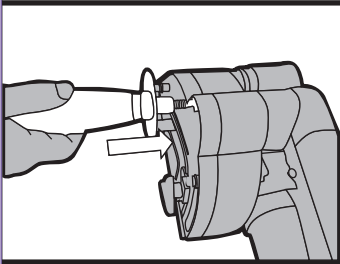

**Fig 26**

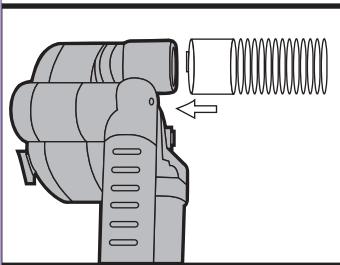

**Fig 27**

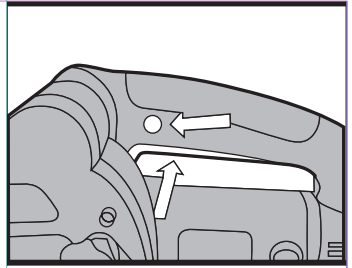

**Fig 28**

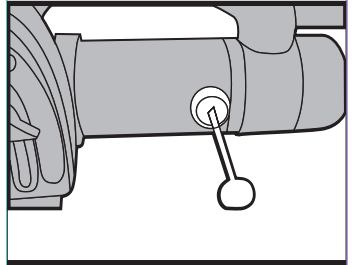

**Fig 29**

# MAINTENANCE

<b>Problem</b>	<b>Possible cause</b>	<b>Solution</b>
The electric motor becomes hot and cuts out.	1)The overheating protection has been activated. 2)The motor is defective.	1) Wait several minutes until the machine has cooled down, then re-start the machine. 2) Take the machine to your dealer for inspection and / or repair.
The machine is switched on but will not run.	1)The overload protection has been activated. 2)The overheating protection has been activated. 3)The switch is damaged.	1) Re-start the machine. 2) Wait several minutes until the machine has cooled down, and then re-start the machine. 3) Take the machine to your dealer for inspection and / or repair.
Cutting is difficult and the channel made is irregular.	The cutting discs are bent or blunt.	Replace the cutting discs.
When cutting, the workpiece begins to vibrate heavily.	The cutting discs are overheated or deformed.	Replace the cutting discs.
The machine runs erratically and / or noisily,	The carbon brushes are worn.	Take the machine to your dealer for replacement of the carbon brushes.



## ENVIRONMENTAL PROTECTION



Waste electrical products should not be disposed of with household waste. Please  recycle where facilities exist. Check with your Local Authority or retailer for recycling advice.

## PLUG REPLACEMENT

The fuse in the main plug of your power tool should always be replaced with one of identical rating.

Check the voltage given on your power tool matches the supply voltage.

The power tool is supplied with a fitted plug, however if you should need to fit a new plug follows the instruction below.

### IMPORTANT

The wire in the mains lead are coloured in accordance with the following code:

**Blue ---Neutral**

**Brown ---Live**

The wire that is coloured blue must be connected to the terminal that is marked with the letter **N**.

The wire that is coloured brown must be connected to the terminal that is marked with the letter **L**.

A 13AMP (BS1363 or BS1363/A) plug must be used and a 13 AMP fuse must be fitted.

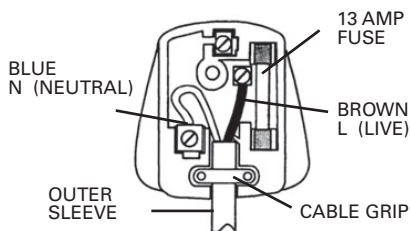

# 1500W WALL CHASER



## Declaration of Conformity

We, Importer

**Screwfix Direct Ltd**  
**Mead Avenue**  
**Houndstone Business Park**  
**Yeovil**  
**BA 22 8RT**

Declare that the product  
**1500W WALL CHASER**  
**ERB125Y**

Complies with the essential health and safety requirements of the following directives:

**89/336/EEC, 93/68/EEC** – EMC Directive.  
**73/23/EEC, 93/68/EEC** – Low Voltage Directive  
**98/37/EC** – Machinery Directive.

Standards and technical specifications referred to:

**EN 60745-1/A1:2003**  
**EN 55014-1/A2:2002**  
**EN 55014-2/A1:2001**  
**EN 61000-3-2:2000**  
**EN 61000-3-3 /A1:2001**

### Authorised Signatory

Date: 15/09/05

Signature: *P. C. Harries*

Name: Peter Harries  
Screwfix Direct Ltd  
Quality Manager



2005

**1500W WALL CHASER**

**Erbauer**®